

A PART OF THE N.E. 1/4 OF SECTION 9, T9N, R3W, I.M.  
NORMAN, CLEVELAND COUNTY, OKLAHOMA

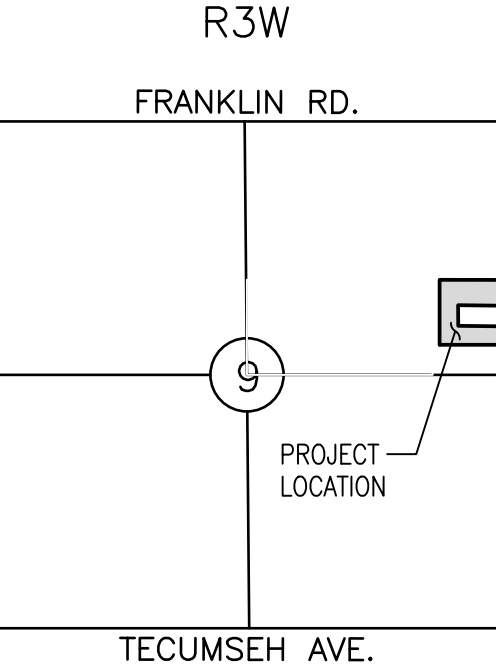

MC CONSULTING ENGINEERS, P.C.  
15 W. MAIN ST.  
KLAHOMA CITY, OK 73106  
(405) 232-7715

HEET NO.  
1

PROP. OUTLET STRUCTURE  
40 L.F. OF 23"x14" RCPHE  
 $FL_{UP} = 1134.58$   
 $FL_{DN} = 1134.50$

✓ P.O.C.

N.E. COR., N.E. 1/4, SEC. 9,  
T9N, R3W, I.M.