

**AMENDMENT NO. 2  
TO AGREEMENT  
FOR  
ENGINEERING SERVICES**

This Amendment No. 2 dated this \_\_\_\_\_ day of \_\_\_\_\_, 2019 is made a part of the Agreement dated April 9, 2015, between the Norman Utilities Authority (OWNER) and C.H. Guernsey & Company (ENGINEER) for professional engineering services.

1. The times for the performance of ENGINEER's services of said Agreement are amended as set forth in Attachment A, attached hereto and incorporated by reference herein.
2. The Scope of Services of ENGINEER of said Agreement is amended and supplemented as described in Attachment B attached hereto and incorporated by reference herein.
3. The method of payment for services rendered by ENGINEER shall be set forth in Attachment C, attached hereto and incorporated by reference herein.

Acceptance of the terms of this Amendment is acknowledged by the following authorized signatures of the parties to the Agreement. All other particulars in the original Agreement, and not specifically referenced in this Amendment No. 2 remain in effect and unchanged.

IN WITNESS WHEREOF, OWNER and ENGINEER have executed this AGREEMENT.

DATED this \_\_\_\_\_ day of \_\_\_\_\_, 2019

**C.H. Guernsey & Company - ENGINEER**

ATTEST

By:

Ken Senou

Title:

Sr. Vice President

Ron Lauer

Asst. Secretary

**Norman Utilities Authority- OWNER**

APPROVED as to form and legality this \_\_\_\_\_ day of \_\_\_\_\_, 2019.

\_\_\_\_\_  
City Attorney

APPROVED by the Trustees of the Norman Utilities Authority this \_\_\_\_\_ day of \_\_\_\_\_, 2019.

ATTEST

By:

Title:

\_\_\_\_\_  
\_\_\_\_\_  
\_\_\_\_\_

\_\_\_\_\_  
\_\_\_\_\_  
\_\_\_\_\_

**ATTACHMENT A**

**SCHEDULE**

ENGINEER shall submit 95 percent contract documents for the project to the OWNER within 30 calendar days following receipt of Amendment No. 2 from the OWNER.

ENGINEER shall complete final contract documents and all other services necessary to allow the OWNER to advertise for bids within 14 calendar days following receipt of OWNER comments on the draft contract documents.

ENGINEER shall provide Construction Services to the OWNER following the successful bidding and award of the project.

ENGINEER shall submit as-built drawings for the project to the OWNER within 30 calendar days after acceptance of construction by OWNER.

Failure of ENGINEER to comply with above schedule for various tasks or subtasks may result in OWNER's termination of this AGREEMENT.

## **ATTACHMENT B**

### SCOPE OF SERVICES

The amended Gray Street Water Line Replacement (PROJECT) will consist of the replacement of existing waterlines and appurtenances as noted below:

1. The project was redefined in Amendment No. 1 and will include completion of surveying, preliminary and final construction contract documents, as well as bidding and construction services. Segments within Amendment No. 1 are defined below:
  - Approximately 1,535 feet of 12-inch waterline along Gray between Flood and University for which design and survey is essentially complete;
  - Approximately 1,390 feet of 12-inch waterline along Gray between University and the railroad;
  - Approximately 1,650 feet of 12-inch waterline along Gray between the railroad and Porter;
  - Approximately 315 feet of 8-inch waterline along Webster from Gray to Main;
  - Approximately 315 feet of 8-inch waterline along Santa Fe from Gray to Main;
  - Approximately 360 feet of 8-inch waterline along Jones from Gray to Main;
  - Approximately 335 feet of 8-inch waterline along University from Gray to Tonhawa;
  - Approximately 350 feet of 8-inch waterline along Peters from Gray to Tonhawa;
  - Approximately 1,900 feet of 8-inch waterline along Tonhawa between Flood and the City complex;
  - Approximately 50 feet of 8-inch waterline along Peters under Gray; and
  - Approximately 50 feet of 8-inch waterline along Crawford under Gray.
2. Additions to the project by Amendment No. 2 are described below:
  - Approximately 334 feet of 8-inch waterline along Gray from Base to Flood;
  - Approximately 350 feet of 8-inch waterline along Base from Gray to Tonhawa;
  - Approximately 334 feet of 8-inch waterline along Tonhawa from Base to Flood;
  - Approximately 350 feet of 8-inch waterline along Flood from Gray to Tonhawa; and
  - Approximately 178 feet of 8-inch waterline along Peters from Tonhawa to Daws.

**ATTACHMENT B (CONTINUED)**

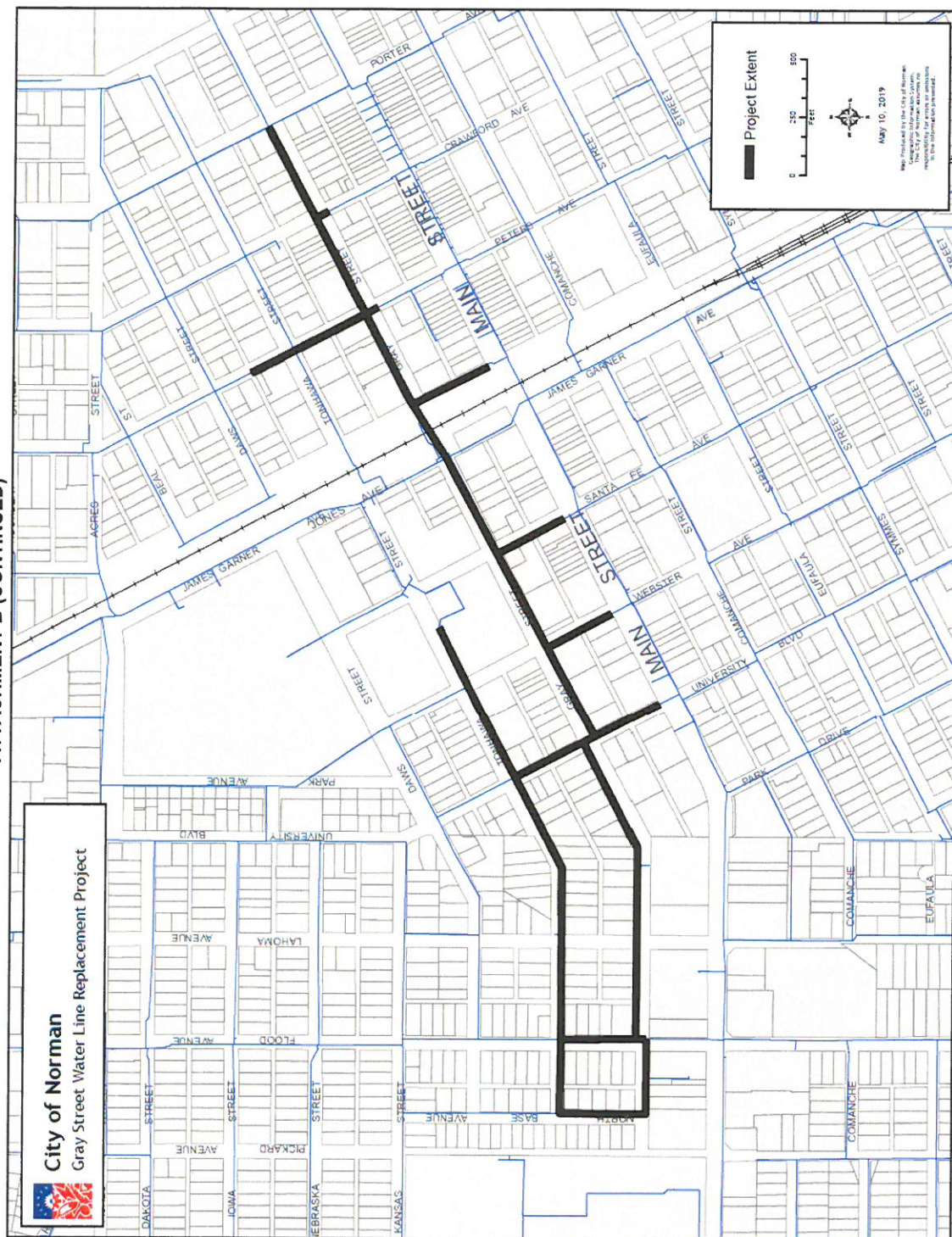



### ATTACHMENT C

Activity	Task Description	Original Amount	Revised Amount (Amendment 1)	Increase (Decrease)	Revised Amount (Amendment 2)
1	Kick-off Meeting and Site Visit	\$2,200	\$6,100	-	\$6,100
2	Perform Topographic Survey*	\$11,700	\$35,500	\$6,500	\$42,000
3	Utility and Public Coordination	\$3,200	\$10,100	\$1,500	\$11,600
4	Preliminary Design	\$9,200	\$26,300	\$4,500	\$30,800
5	Final Plans, Specifications and Contract Documents	\$7,900	\$22,600	\$10,500	\$33,100
6.a	Bidding	\$4,400	\$9,500	\$1,500	\$11,000
6.b	Construction Support	n/a	\$12,600	\$1,500	\$14,100
7	As-Built Drawings	\$800	\$3,900	\$500	\$4,400
	Total Fee	\$39,400	\$126,600	\$26,500	\$153,100

Each Revised Amount includes fee for original contract and previous amendments. The estimated construction cost for the complete project is \$1,100,000.