

Muirfield, Inc.
2405 Wilcox Drive
Norman, OK 73069

July 9, 2018

City Clerk
City of Norman
201 West Gray
Norman, OK 73069

Petition:

At the property located at 914 West Timberdell Road, Lot 8-Block 1 of Willow Brook Addition we are requesting to close and vacate the platted building line.

Requesting to establish the new structure at a 49' setback, a 6' variance from the platted 55' build line.

It is our opinion that we are not requesting anything that has not been approved in the past. It appears that a precedent has been set on this street previously with a couple of other homes on the street that have encroached the 55' build line. I have attached an aerial photo from Norman's Interactive Map showing the building and easement lines. The property structures on each side of our property have both built over the 55' building line.

We appreciate your consideration of our request.

Faithfully Submitted,



Muirfield Inc.
Alan R. Cheshier, President

FILED IN THE OFFICE
OF THE CITY CLERK
ON 7-11-18

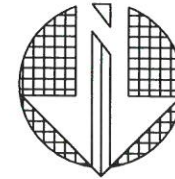
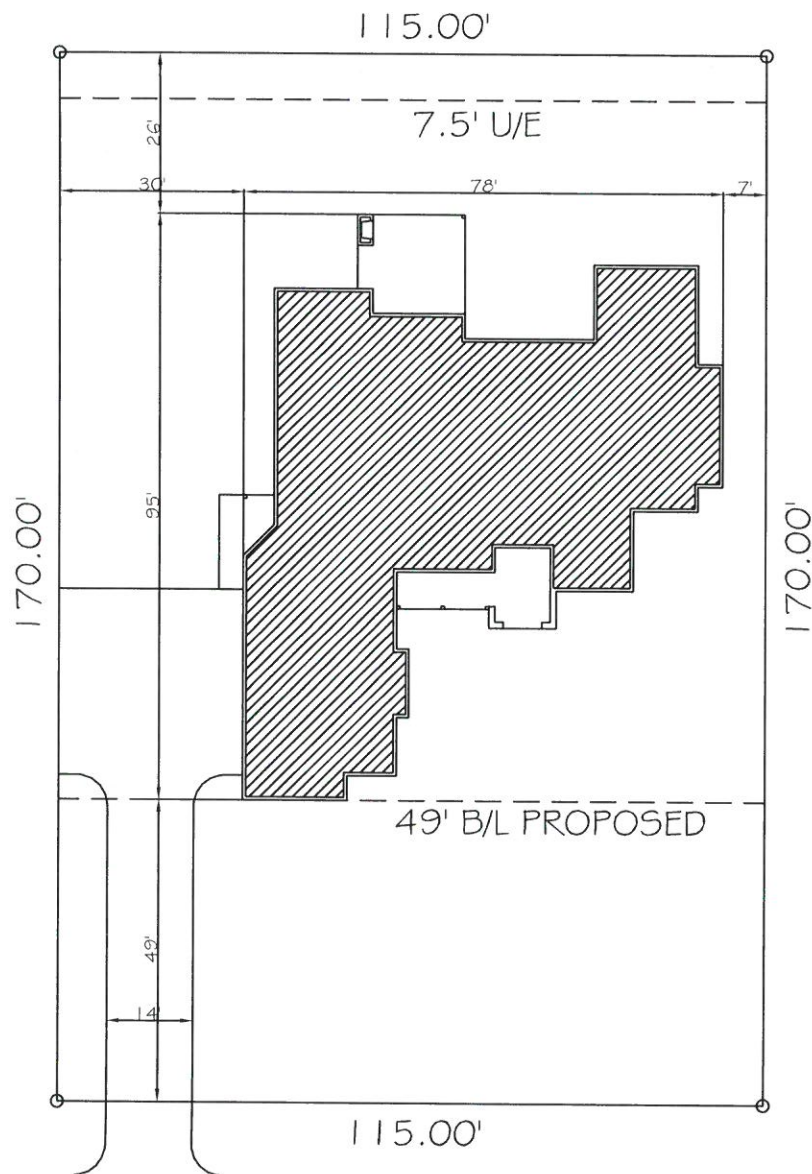

SCALE: 1"=30'

WILLOW BROOK ADD.
 LOT 8, BLOCK 1
 NORMAN, CLEV. CO., OK
 LAND AREA: 19,550 SQ.FT.

914 W. TIMBERDELL RD.

THESE PLANS WERE
 PREPARED BY THE
 FIRM OF PREFERRED
 PLANS, INC. FOR THE
 PROPERTY OF THE
 PROPERTY OWNER. THE
 FIRM OF PREFERRED
 PLANS, INC. IS NOT
 RESPONSIBLE FOR THE
 ACCURACY OF THE
 INFORMATION CONTAINED
 HEREIN.

DATE:
 2/9/2008

SCALE:
 1/8"=1'-0"

FIRST FLOOR FRAME:

SECOND FLOOR FRAME:

TOTAL FRAME:

TOTAL VENEER:

GARAGE FRAME:

GARAGE VENEER:

COVERED PORCH:

COVERED PATIO:

2800 VAN LUREN, STE. 2002
 NORMAN, OK 75072
 TEL: 540933417 68994
 www.ppreferred-plans.net



PLOT PLAN

1

WILLOW BROOK ADDITION

STATE OF OKLAHOMA
COUNTY OF CLEVELAND
FILED FOR RECORD
10-10-56
3 47
HELEN J. WING, Clerk
By: *[Signature]* Deputy
11,143

WILLOW BROOK ADD'N. TO NORMAN, OKLAHOMA

OWNERS CERTIFICATE & DEDICATION:

WE, THE JULIA SMITH TRUSTS, OWNERS OF THAT PART OF NE $\frac{1}{4}$ OF SW $\frac{1}{4}$ OF SECTION 6-T8N-R2W OF I.M. DESCRIBED AS FOLLOWS: ALL OF THE N $\frac{1}{2}$ OF NE $\frac{1}{4}$ OF SW $\frac{1}{4}$, EXCEPT THE WEST 4 FEET AND THAT PORTION OF SAID N $\frac{1}{2}$ DESCRIBED AS FOLLOWS: BEGINNING AT THE NE CORNER OF SAID N $\frac{1}{2}$; THENCE WEST 213 FEET; THENCE SOUTH 257 FEET; THENCE EAST 213 FEET; THENCE NORTH 257 FEET TO THE POINT OF BEGINNING; DO HEREBY CERTIFY THAT WE ARE THE OWNERS OF AND THE ONLY PERSONS WHO HAVE ANY RIGHT, TITLE OR INTEREST IN THE LAND DESCRIBED ABOVE AND AS SHOWN ON THE ANNEXED MAP; THAT SAID MAP IS A CORRECT SURVEY OF SAID PROPERTY MADE WITH OUR CONSENT; THAT WE DO HEREBY DEDICATE TO THE PUBLIC USE OF ALL STREETS AND EASEMENTS AS SHOWN ON THE ANNEXED MAP; THAT WE HEREBY GUARANTEE A CLEAR TITLE TO THE LAND SO DEDICATED FROM OURSELVES, OUR HEIRS OR ASSIGNEES FOREVER.

WITNESS OUR HANDS & SEALS THIS 30th DAY OF APRIL, 1956

JULIA SMITH TRUSTS
BY: *[Signature]* Trustee
E.A. FARIS, TRUSTEE

STATE OF OKLAHOMA }
COUNTY OF CLEVELAND } ss

SCALE: 1"=100'
ON THIS 30th DAY OF APRIL 1956, BEFORE ME THE UNDERSIGNED, A NOTARY PUBLIC IN AND FOR THE COUNTY AND STATE AFORESAID, PERSONALLY APPEARED, E.A. FARIS, TO ME KNOWN TO BE THE IDENTICAL PERSON WHO SIGNED THE NAME OF THE MAKER THEREOF TO THE WITHIN AND FOREGOING INSTRUMENT AS ITS, TRUSTEE, AND ACKNOWLEDGED TO ME THAT HE EXECUTED THE SAME AS HIS FREE AND VOLUNTARY ACT AND DEED, AND AS THE FREE AND VOLUNTARY ACT AND DEED AS SAID TRUSTEE, FOR THE USES AND PURPOSES THEREIN SET FORTH.

GIVEN UNDER MY HAND AND SEAL THE DAY AND YEAR LAST ABOVE WRITTEN.
MY COMMISSION EXPIRES 10-14-58 *[Signature]*
NOTARY PUBLIC

SURVEYORS CERTIFICATE:

I, E.H. DURKEE, THE UNDERSIGNED DO HEREBY CERTIFY THAT I AM BY PROFESSION A SURVEYOR AND THAT THE ANNEXED MAP OF WILLOW BROOK ADDITION CORRECTLY REPRESENTS A SURVEY MADE UNDER MY SUPERVISION ON THE 28th DAY OF MAR, 1956, AND ALL THE MONUMENTS SHOWN THEREON ACTUALLY EXIST AND THEIR POSITIONS ARE CORRECTLY SHOWN.

SUBSCRIBED AND SWORN TO BEFORE ME THIS 30th DAY OF APRIL 1956
MY COMMISSION EXPIRES 10-14-58 *[Signature]*
NOTARY PUBLIC

CITY PLANNING COMMISSION CERTIFICATE:

I, JOE CHATMAN, SECRETARY OF THE CITY PLANNING COMMISSION OF THE CITY OF NORMAN, OKLAHOMA DO HEREBY CERTIFY THAT SAID PLANNING COMMISSION DID APPROVE THE ANNEXED MAP OF WILLOW BROOK ADDITION AT A MEETING HELD ON THE 15th DAY OF MAY 1956

[Signature]
JOE CHATMAN
SECRETARY PLANNING COMMISSION

CITY COMMISSION CERTIFICATE:

I, PAUL V. KEEN, MAYOR OF THE CITY COMMISSION OF THE CITY OF NORMAN, OKLAHOMA DO HEREBY CERTIFY THAT SAID CITY COMMISSION DID APPROVE AND ACCEPT THE ANNEXED MAP OF WILLOW BROOK ADDITION AT A MEETING HELD ON THE 12th DAY OF JUNE 1956

ATTEST: *[Signature]*
CITY CLERK

[Signature]
PAUL V. KEEN
MAYOR

LEGEND

- THIS ADDITION
- - - - - BLDG. LINES
- - - - - EASEMENT LINES
- - - - - PROPOSED ADDITION
- - - - - 1/2 SEC. LINES
- IRON PINS

CERTIFICATE OF BONDED ABSTRACTOR.

THE UNDERSIGNED, A DULY QUALIFIED AND LAWFULLY BONDED ABSTRACTOR OF TITLES IN AND FOR THE STATE OF OKLAHOMA, HEREBY CERTIFIES THAT THE RECORDS OF THE COUNTY OF CLEVELAND AND STATE OF OKLAHOMA, SHOW TITLE TO LANDS INDICATED IN THE ANNEXED MAP OF WILLOW BROOK ADDITION ARE IN THE NAMES AS SET OUT ABOVE IN THE OWNERS CERTIFICATE AND DEDICATION ONLY, AND THAT ON THE 2nd DAY OF MAY 1956, THERE ARE NO ACTIONS OR JUDGMENTS OF ANY NATURE IN ANY COURT OR, ON FILE WITH THE CLERK OF ANY COURT IN SAID COUNTY AND STATE, AGAINST SAID LANDS OR THE OWNERS THEREOF, THAT NO TAXES AGAINST SAID LANDS ARE DUE OR UNPAID NO TAX SALES UNREDEEMED, NO TAX DEBTS GIVEN, NO PERSONAL TAXES AGAINST THE SAID OWNERS DUE OR UNPAID; AND THAT THERE ARE NO LIENS, MORTGAGES OR ENCUMBRANCES OF ANY KIND AGAINST THE SAID LANDS DEDICATED TO PUBLIC USE.

Security Abstract Co.
By: *[Signature]*
BONDED ABSTRACTOR

