

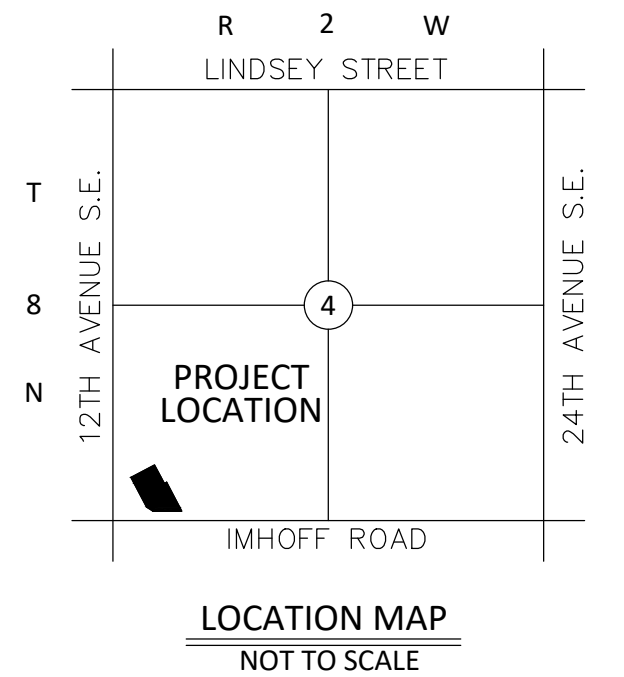

FINAL PLAT

WASH FACTORY CLASSEN ADDITION

A REPLAT OF LOT 1 AND 2, BLOCK 1 SHORT FORM PLAT NO. SFP-1516-1
A PART OF THE S.W. 1/4, SECTION 4, T. 8 N., R. 2 W., I.M.
NORMAN, CLEVELAND COUNTY, OKLAHOMA



BENCHMARK - BM	
ELEVATION	1149.28
MONUMENT	BRASS CAP ON TOP OF CURB
LOCATION	N.E. CORNER OF ACCESS DRIVE NEAR N.E. PROPERTY CORNER

Line #	Direction	Length
L1	S 27°55'27" E	15.37
L2	S 74°44'54" W	87.28
L3	N 74°44'54" E	141.93
L4	S 89°14'30" W	59.94
L5	S 89°14'30" W	33.72
L6	N 59°09'09" W	15.45
L7	N 16°56'12" E	15.71
L8	S 16°56'12" W	8.81
L9	S 87°31'04" W	96.64
L10	N 87°31'04" E	103.86
L11	N 62°02'15" E	56.00
L12	S 62°02'15" W	74.38
L13	S 27°55'27" E	155.33
L14	N 27°55'27" W	155.44
L15	S 27°55'27" E	223.04
L16	N 27°55'27" W	221.07
L17	N 62°04'33" E	24.03
L18	N 89°14'30" E	19.93
L19	S 89°14'30" W	19.93

Curve #	Radius	Length	Delta	Tangent	Chord Bearing	Chord Length
C1	25.00'	30.28'	69°23'29"	17.31'	S 06°46'17" W	28.46'
C2	49.00'	63.53'	74°16'55"	37.11'	N 09°13'01" E	59.17'
C3	25.00'	34.06'	78°04'07"	20.27'	N 07°19'25" E	31.49'
C4	49.00'	61.00'	71°19'20"	35.16'	S 05°48'22" W	57.13'
C5	25.00'	27.42'	062°50'03"	15.27'	S 59°20'28" E	26.06'
C6	60.00'	79.60'	076°00'54"	46.89'	S 52°45'03" E	73.89'
C7	10.00'	2.60'	014°53'29"	1.31'	N 27°24'23" W	2.59'
C8	30.00'	29.27'	055°54'23"	15.92'	N 62°48'19" W	28.12'
C9	55.00'	60.32'	062°50'03"	33.59'	N 59°20'28" W	57.34'

P.O.C. FND. 0001 BRASS CAP 14-493
S.W. CORNER, S.W. QUARTER
SECTION 4, T. 8 N., R. 2 W., I.M.
PER OCCR BY DERRICK E. ANDERSON, PLS 1551
DATED: APRIL 29, 2004



LEGAL DESCRIPTION

A part of the Southwest Quarter (SW/4) of the Southwest Quarter (SW/4) of Section Four (4), Township Eight (8) North, Range Two (2) West of the Indian Base and Meridian, Cleveland County, State of Oklahoma, according to the United States Government Survey thereof, and being more particularly described as follows:

- COMMENCING at the Southwest Corner of said Section Four (4);
- THENCE North 89°14'30" East, along the South line of said Section Four (4) for a distance of 513.40 feet (Record), 508.14 (Measured) to a point on the 40.00 feet East Right-of-Way line of U.S. Highway No. 77 as established in Book 193, Page 364;
- THENCE North 27°55'27" West, along said Right-of-Way line a distance of 93.06 feet to the POINT OR PLACE OF BEGINNING;
- THENCE continuing North 27°55'27" West and along said Right-of-Way for a distance of 261.99 feet;
- THENCE North 62°04'33" East for a distance of 210.50 feet;
- THENCE South 27°55'27" East for a distance of 165.00 feet;
- THENCE North 62°04'33" East for a distance of 20.00 feet;
- THENCE South 27°55'27" East for a distance of 252.07 feet to a point 50.0 feet North of the South line of said Southwest Quarter (SW/4);
- THENCE South 89°14'30" West for a distance of 222.61 feet;
- THENCE North 59°09'09" West for a distance of 62.58 feet to the POINT OR PLACE OF BEGINNING.

Said described tract of land contains an area of 78,604 square feet or 1.8045 acres, more or less.

ALSO BEING FORMERLY DESCRIBED AS FOLLOWS:

Lot 1 and 2, of Block 1, in SHORT FORM PLAT LADY DI, also known as SHORT FORM PLAT NO. SFP-1516-1, recorded in Book 5485, Page 952, in the Office of the County Clerk of Cleveland County, Oklahoma, according to the recorded plat thereof.

NOTES

- The bearing of North 89°14'30" East along the south line of the Southwest Quarter of Section 4, Township 8 North, Range 2 West of the Indian Meridian, as shown hereon, was used as the basis of bearings for this plat.
- Existing easements shown hereon by specific recording information are shown for reference purposes only and are not dedicated pursuant to this final plat.
- 1/2" iron pins with CA6391 caps or mag nails with CA6391 tags set at all property corners unless otherwise stated.
- Tract 1 contains 33,691 square feet or 0.7734 acres.
Tract 2 contains 44,913 square feet or 1.0311 acres.

FND. MAG NAIL W/LS1349 TAG
S.E. CORNER, S.W. QUARTER
SECTION 4, T. 8 N., R. 2 W., I.M.
PER OCCR BY DERRICK E. ANDERSON, PLS 1551
DATED: APRIL 29, 2004

ENGINEER
HOMER ENGINEERING, INC.
206 ELM STREET, SUITE 105
LEWISVILLE, TEXAS 75057
(972) 906-9985
CA6112 EXPIRES JUNE 30, 2019

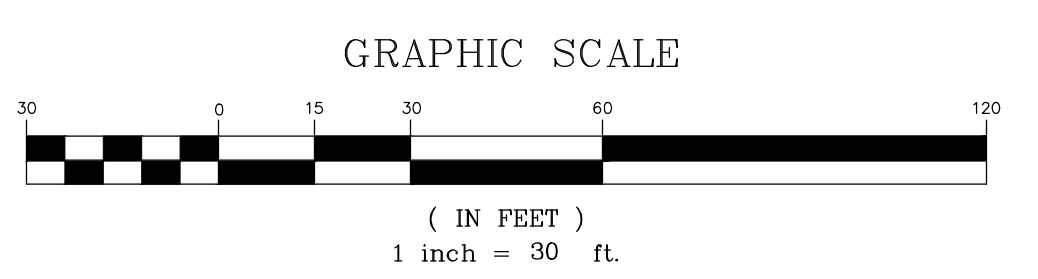

DODSON - THOMPSON - MANSFIELD, PLLC

20 NE 38th Street Phone: 405-601-7402 email: randym@dtm-oc.com
Oklahoma City, OK 73105 Fax: 405-601-7421
Surveying - Engineering - Earthwork
CERTIFICATE OF AUTHORIZATION NO: 6391 EXPIRES JUNE 30, 2018