

OVERALL SITE PLAN
SCALE: 1" = 60'-0"

CITY OF NORMAN
ACCOUNT NO. R0067823
PARCEL NO. 5D24 & 2N 7004

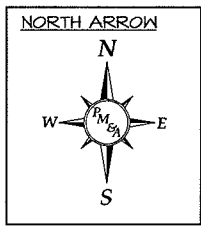
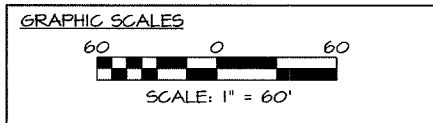

NUM	DATE	DESCRIPTION
A	5/30/11	PRELIM.
B	5/24/11	PRELIM
O	9/14/11	FINAL

ANIMAL WELFARE
OVERALL SITE PLAN

DESIGNER: EEC
DRAWN: EEC
CHECKED: AP

JOB #: HAR-OK-1501

NUM	DATE	DESCRIPTION
A	6/30/17	PRELIM.
B	8/24/17	PRELIM
C	9/14/17	FINAL

DETAILED SITE PLAN

BY ANIMAL WELFARE

DESIGNED: EEC
DRAWN: EEC
CHECKED: AP

JOB # HAR-OK-1501

C-3

- KEY NOTES:**
- PROPOSED 80 KW GENERATOR INSIDE EQUIPMENT SHELTER
 - PROPOSED ICE-BRIDGE
 - PROPOSED SELF-SUPPORT TOWER
 - PROPOSED UTILITY H-FRAME W/ PROPOSED METER DISCONNECT
 - PROPOSED 13'-0" x 32'-0" EQUIPMENT SHELTER
 - PROPOSED 12'-0" CHAINLINK GATE
 - PROPOSED CHAINLINK FENCE
 - PROPOSED (2) HVAC (EQUIPMENT FURNISHED WITH SHELTER)
 - PROPOSED AUTOMATIC TRANSFER SWITCH (ATS), MANUAL TRANSFER SWITCH (MTS), MAIN DISTRIBUTION PANEL (MDP), & TECHNICAL PANEL MOUNTED ON INTERIOR SHELTER WALL. (EQUIPMENT FURNISHED WITH SHELTER)
 - PROPOSED 1000 GAL LP TANK ON CONCRETE PAD
 - PROPOSED 12'-0" GRAVEL ACCESS ROAD
 - PROPOSED GRAVEL COMPOUND SURFACE

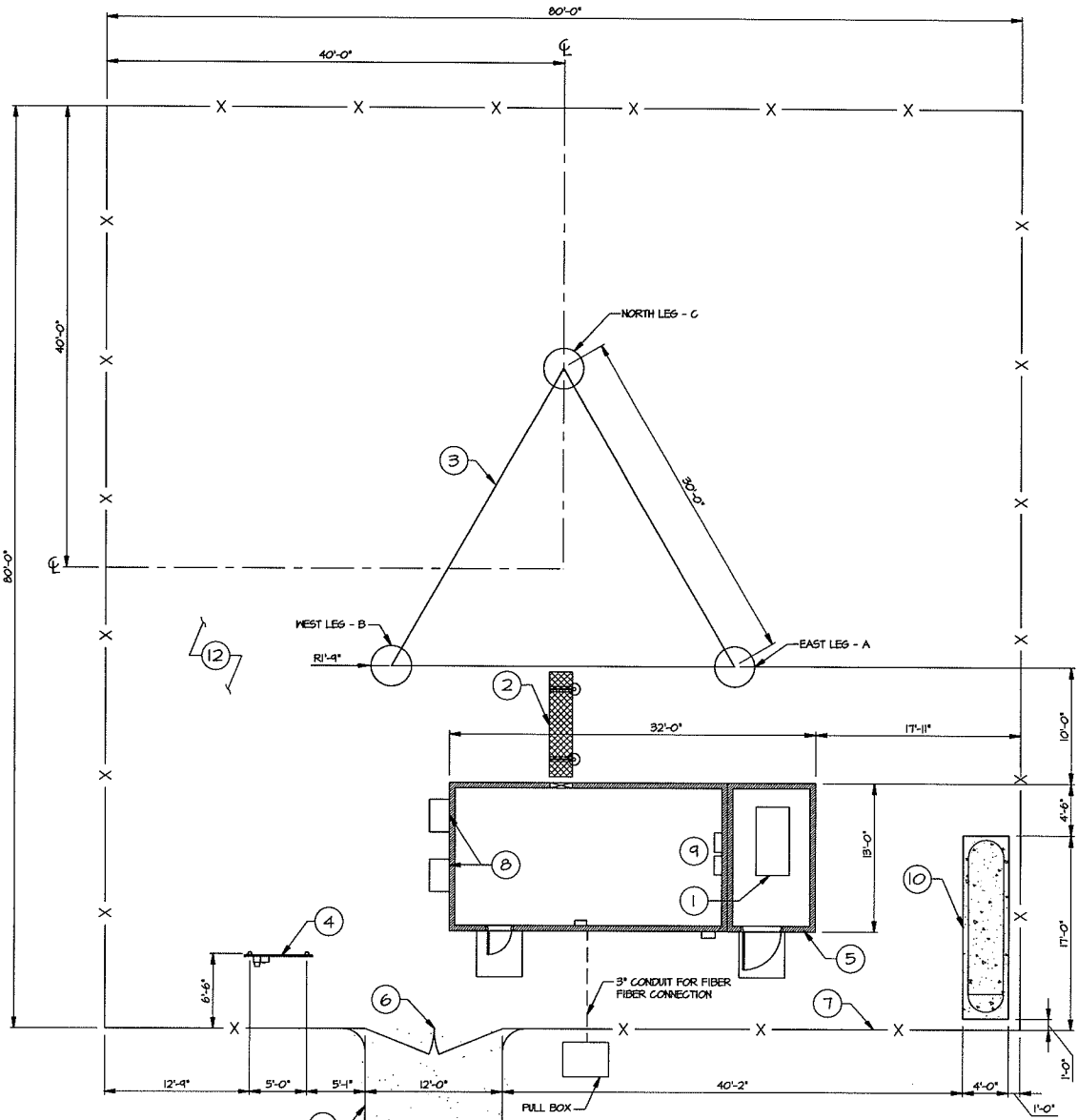
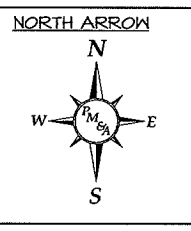
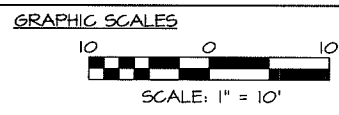

COMPOUND PLAN
SCALE: 1" = 10'-0"