

FINAL PLAT
HEARTLAND CHURCH ADDITION
 A PLANNED UNIT DEVELOPMENT
 A PART OF THE N.W. 1/4, SECTION 18, T9N, R2W I.M.
 NORMAN, CLEVELAND COUNTY, OKLAHOMA

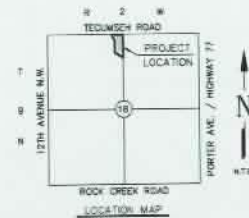

SCALE: 1" = 80'

THE BEARING OF $S 89^{\circ}18'12'' E$ ON THE NORTH LINE OF THE NORTHWEST QUARTER OF SECTION 18 PER THE CITY OF NORMAN, O.K. IS USED AS THE BASIS OF BEARING FOR THIS PLAT.

TOTAL LOTS = 1

BEING: 1ST BRASS ON AT
 N.E. COR. OF THE N.W. 1/4
 T2N -

U/E = UTILITY EASEMENT
 L/E = LANDSCAPE EASEMENT
 -1000- = ADDRESS

NOTE: THE UNIT OF MEASUREMENT SHOWN FOR ALL DIMENSIONS ON THE FINAL PLAT IS FEET.

Final Plat Prepared by:
 SMC Consulting Engineers, P.C.
 215 W. Main Street
 Oklahoma City, OK 73106
 Ph: (405) 252-1715
 Oklahoma CA#484 Exp. 6/30/15

HEARTLAND CHURCH ADDITION
 A PLANNED UNIT DEVELOPMENT
 FINAL PLAT SHEET 2 OF 2