

DO NOT WRITE IN THIS SPACE

OFFICIAL OKLAHOMA TRAFFIC COLLISION REPORT

Incident Report Investigation Completed Investigation Made at Scene Photographs

(1) Reporting Agency MOORE POLICE DEPARTMENT Case Number (Agency Use) 16-28557 Motor Vehicles Involved 02 Number Injured 01 Number Killed 00

(2) Date of Collision (mm/dd/yyyy) 08152016 Time 0955 County Number and Name 14 CLEVELAND Nearest City or Town Number and Name 10 MOORE

(3) Distance from Nearest City or Town Limits Control # Int ID Location East Grid North Grid Administrative

(4) Street, Road or Highway BELMAR CIR Distance from At (Nearest) Intersecting Street, Road or Highway INDIAN HILLS RD.

(5) Unit Occupants Type Hit & Run Last Name DECKER-GALEY YVONNE First D Middle Suffix Date of Birth (mm/dd/yyyy) Sex F

(6) Address City State Zip Telephone (Use Area Code)

(7) Driver License Number State Class Endorsement(s) Restriction(s) Inj. Sev. Type of Injury Drv./Ped. Cond. OP Use

(8) Ejected Extricated Test (% BAC) Transported by To Medical Facility License Plate Number State Month Year

(9) VIN Vehicle Year Color 2nd Color Make Model Veh. Conf. Extent of Damage

(10) Insurance Company Name Policy Number Insurance Telephone (Use Area Code)

(11) Vehicle Removed by Driver R&R RECOVERY Owner's Last Name First Middle Suffix

(12) Owner's Address City State Zip Towed Veh. Type Oversized Load Rollover Burned Phone present Phone in use

(13) Citation Number Statute/Ordinance Number Citation Number Statute/Ordinance Number

(14) Unit Occupants Type Hit & Run Last Name COLON CYNTHIA First S Middle Suffix Date of Birth (mm/dd/yyyy) Sex F

(15) Address City State Zip Telephone (Use Area Code)

(16) Driver License Number State Class Endorsement(s) Restriction(s) Inj. Sev. Type of Injury Drv./Ped. Cond. OP Use

(17) Ejected Extricated Test (% BAC) Transported by To Medical Facility License Plate Number State Month Year

(18) VIN Vehicle Year Color 2nd Color Make Model Veh. Conf. Extent of Damage

(19) Insurance Company Name Policy Number Insurance Telephone (Use Area Code)

(20) Vehicle Removed by Driver CITY OF NORMAN Owner's Last Name First Middle Suffix

(21) Owner's Address City State Zip Towed Veh. Type Oversized Load Rollover Burned Phone present Phone in use

(22) Citation Number Statute/Ordinance Number Citation Number Statute/Ordinance Number

(23) Investigating Officer J. CAMPBELL Badge Number Troop/Div. Reviewer (Init.) Reviewer Badge Number Date of Report (mm/dd/yyyy)

Table with columns: Unit Type, Injury Severity, Type of Injury, Driver/Pedestrian Condition, Occupant Protection (OP) In Use, Air Bag Deployed, Ejected, Extricated, Chemical Test, Extent of Damage, Insurance Verification, Oversized Load, Towed Vehicle Type.

WARNING - STATE LAW Use of contents for commercial solicitation is unlawful DPS: 01 92-01 REV 0107

(24) Unit	Injured <input type="checkbox"/> Witness <input checked="" type="checkbox"/>	Passenger <input type="checkbox"/> Prop. Owner <input type="checkbox"/>	Pos in Veh.	Last Name	First	Middle Initial	Date of Birth (mm/dd/yyyy)	Sex
				FITZGERALD,	PATRICK	T		M
(25) Address	City		State	Zip	Telephone (Use Area Code)			
Same as Driver			OK	73070				
(26) Injury Severity / Type	OP Use	Air Bag	Ejected	Extricated	Transported by	To Medical Facility	Property Type	
(27) Unit	Injured <input type="checkbox"/> Witness <input checked="" type="checkbox"/>	Passenger <input type="checkbox"/> Prop. Owner <input type="checkbox"/>	Pos in Veh.	Last Name	First	Middle Initial	Date of Birth (mm/dd/yyyy)	Sex
				FITZGERALD,	BARBRA	K		F
(28) Address	City		State	Zip	Telephone (Use Area Code)			
Same as Driver			OK	73070				
(29) Injury Severity / Type	OP Use	Air Bag	Ejected	Extricated	Transported by	To Medical Facility	Property Type	
(30) Unit	Injured <input type="checkbox"/> Witness <input type="checkbox"/>	Passenger <input type="checkbox"/> Prop. Owner <input type="checkbox"/>	Pos in Veh.	Last Name	First	Middle Initial	Date of Birth (mm/dd/yyyy)	Sex
(31) Address	City		State	Zip	Telephone (Use Area Code)			
Same as Driver								
(32) Injury Severity / Type	OP Use	Air Bag	Ejected	Extricated	Transported by	To Medical Facility	Property Type	
(33) Unit	Injured <input type="checkbox"/> Witness <input type="checkbox"/>	Passenger <input type="checkbox"/> Prop. Owner <input type="checkbox"/>	Pos in Veh.	Last Name	First	Middle Initial	Date of Birth (mm/dd/yyyy)	Sex
(34) Address	City		State	Zip	Telephone (Use Area Code)			
Same as Driver								
(35) Injury Severity / Type	OP Use	Air Bag	Ejected	Extricated	Transported by	To Medical Facility	Property Type	

Complete information below if this vehicle is being used for COMMERCIAL BUSINESS AND HAS A GVWR IN EXCESS OF 10,000 LBS. or has a HAZMAT PLACARD or is a BUS WITH SEATING FOR NINE OR MORE INCLUDING THE DRIVER

(36) Unit	Carrier Name	Address	
(37) City	State	Zip	
(38) U.S. DOT Number	Vehicle Inspection Number	Placard Number	Haz. Mat. Class
	OK		
(39) Unit	Carrier Name	Address	
(40) City	State	Zip	
(41) U.S. DOT Number	Vehicle Inspection Number	Placard Number	Haz. Mat. Class
	OK		

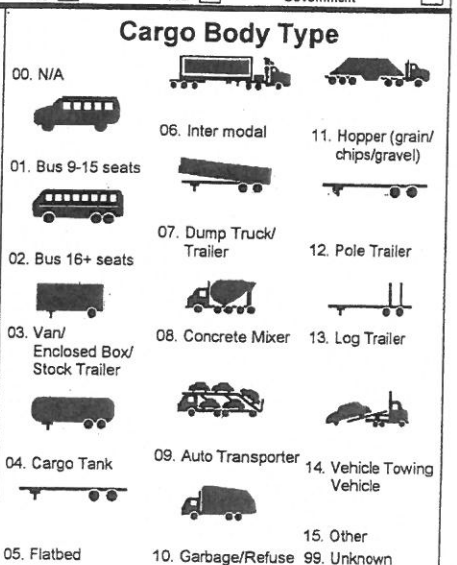
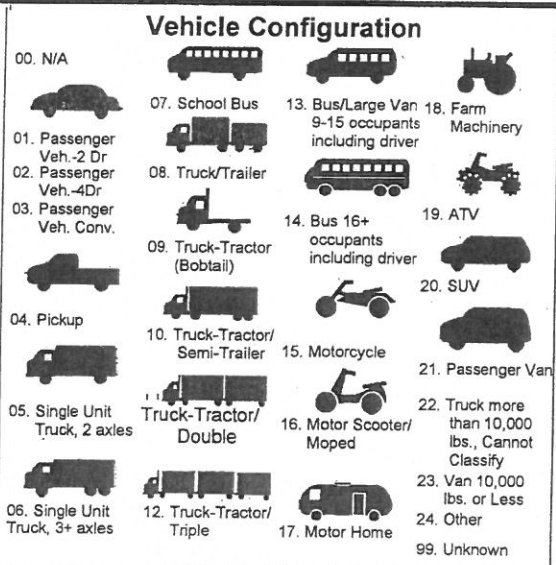
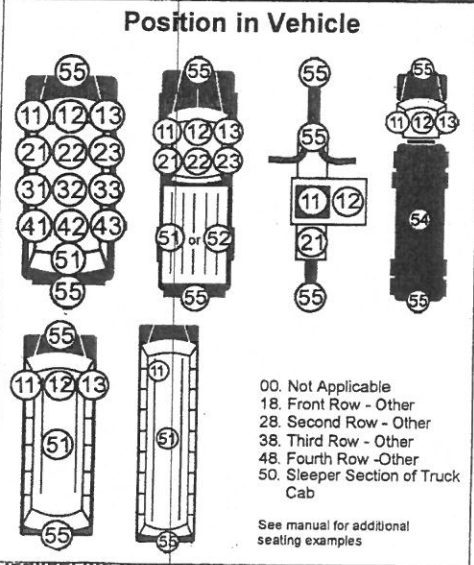

Unit	Total Lanes in Roadway	Legal Speed	Pedestrian / Pedalcyclist Only			
01	03	25	Actions Prior to Collision	Location at Time of Collision	Safety Equip.	Unit Number of Vehicle Striking
01	03	25				

Light

1 Daylight
2 Dark-Not Lighted
3 Dark-Lighted
4 Dawn
5 Dusk
6 Dark-Unknown Lighting
7 Other
9 Unknown

What Vehicle Was Going to Do

00 Not Applicable
01 Go Ahead
02 Turn Left
03 Turn Right
04 Make "U" Turn
05 Stop
06 Slow for Cause
07 Start from Park/Stop
08 Change Lanes
09 Overtake
10 Pass
11 Back
12 Remain Stopped
13 Remain Parked
14 Enter/Merge in Traffic
15 Negotiate a Curve
16 Park
17 Other
99 Unknown

Underride/Override

0 Not Applicable
1 No Underride or Override
2 Underride, Compartment Intrusion
3 Underride, No Compartment intrusion
4 Underride, Compartment Intrusion Unknown
5 Override, Motor Vehicle in Transport
6 Override, Other Motor Vehicle
9 Unknown

Weather

01 Clear
02 Fog/Smog/Smoke
03 Cloudy
04 Rain
05 Snow
06 Sleet/Hail (Freezing Rain/Drizzle)
07 Severe Crosswind
08 Blowing Snow
09 Blowing Sand, Soil, Dirt
10 Other
99 Unknown

What Vehicle Did

00 Not Applicable
01 Went Ahead
02 Turned Left
03 Turned Right
04 Entered "U" Turn
05 Stopped
06 Slowed
07 Started From Park/Stop
08 Entered Other Lane
09 Overtaking
10 Passing
11 Backed
12 Remained Stopped
13 Remained Parked
14 Entered/Merged
15 Departed Rdwy-Right
16 Departed Rdwy-Left
17 Swerved Right
18 Swerved Left
19 Parked
20 Other
99 Unknown

Traffic Control

00 No Control
01 Stop Sign
02 Traffic Signal
03 Flashing Traffic Signal
04 School Zone Signs
05 Yield Sign
06 Warning Sign
07 Railroad Advance Warning Sign
08 Railroad Cross Bucks
09 Railroad Gates
10 Railroad Signal
11 No Passing Zone
12 Person (including flagger, law enforcement, crossing guard, etc.)
13 Abnormal Control
14 Other
99 Unknown

Locality

1 Residential
2 Business
3 Industrial
4 School
5 Not Built-up
6 Mixed Use
7 Other
9 Unknown

Visibility Obscured By

00 Not Applicable
01 Trees
02 Embankment
03 Building
04 Signs
05 Parked Vehicles
06 High Weeds
07 Fences
08 Shrubbery
09 Ice, Snow or Frost on Windows
10 Smoke
11 Fog
12 Dust
13 Rain
14 Sun
15 Other
99 Unknown

Road Surface Conditions

01 Dry
02 Wet
03 Ice/Frost
04 Snow
05 Mud, Dirt, Gravel
06 Slush
07 Water (standing, moving)
08 Sand
09 Oil
10 Other
99 Unknown

Type of Intersection

0 Not an Intersection
2 Y-Intersection
3 T-Intersection
4 Four-Way Intersection
5 Five-Point or More Intersection as Part of Interchange
7 Traffic Circle
8 Roundabout
9 Unknown

Visibility Obscured By

00 Not Applicable
01 Trees
02 Embankment
03 Building
04 Signs
05 Parked Vehicles
06 High Weeds
07 Fences
08 Shrubbery
09 Ice, Snow or Frost on Windows
10 Smoke
11 Fog
12 Dust
13 Rain
14 Sun
15 Other
99 Unknown

Road Character

Grade

1 Level
2 Hillcrest
3 Uphill
4 Downhill
5 Sag (bottom)

Road Alignment

1 Straight
2 Curve - Left
3 Curve - Right

Incident Type

00 Not an Incident
51 Private Property
52 Deliberate Intent
53 Medical Condition
54 Legal Intervention
55 Suicide
57 Drowning
58 Other

Visibility Obscured By

00 Not Applicable
01 Trees
02 Embankment
03 Building
04 Signs
05 Parked Vehicles
06 High Weeds
07 Fences
08 Shrubbery
09 Ice, Snow or Frost on Windows
10 Smoke
11 Fog
12 Dust
13 Rain
14 Sun
15 Other
99 Unknown

Road Character

Grade

1 Level
2 Hillcrest
3 Uphill
4 Downhill
5 Sag (bottom)

Road Alignment

1 Straight
2 Curve - Left
3 Curve - Right

Location of First Harmful Event

01 On Roadway
02 Shoulder
03 Median
04 Roadside
05 Gore
06 Separator
07 Parking Lane/Zone
08 Off Roadway, Location Unknown
09 Outside Right-of-Way
10 Other
99 Unknown

Driver Distracted By

0 Not Applicable/None
1 Electronic Communication Devices
2 Other Electronic Device
3 Other Inside Vehicle
4 Other Outside Vehicle
9 Unknown

Road Surface Type

1 Concrete
2 Asphalt
3 Gravel
4 Dirt
5 Brick
6 Other
7 Unknown

Was the collision in or near a construction, maintenance or utility work zone? (if yes, complete this section) Yes No

Type of Work Zone

1 Lane Closure
2 Lane Shift/Crossover
3 Work on Shoulder or Median
4 Intermittent or Moving Work
9 Unknown

Location of the Work Zone Collision

1 Before the First Work Zone Warning Sign
2 Advance Warning Area
3 Transition Area
4 Activity Area
5 Termination Area
9 Unknown

Workers Present Yes No Unknown

Trafficway

0 Not Applicable
1 One Way
2 Two-Way - Not Divided
3 Two-Way - Divided
4 Two-Way - Divided - Positive Median Barrier
5 Turn Lane
6 Ramp / Loop
7 Driveway
8 Alley / Parking Lot
9 Unknown

Unsafe / Unlawful Contributing Factors

Unit 1 9 8 **Unit 2** 3 4

FAILED TO YIELD

01 From Stop Sign
02 From Yield Sign
03 Private Drive
04 County Road at Through Highway
05 From Signal Light
06 From Alley
07 To Pedestrian
08 To Vehicle on Right Intersection
09 To Vehicle in Intersection
10 To Emergency Vehicles
12 Other

FOLLOWED TOO CLOSELY

13 Human Element
14 Traffic Condition
15 Weather Condition

UNSAFE SPEED

16 Driver's Ability (Aged)
17 Inexperienced Driver - Young
18 Exceeding Legal Limit
19 For Traffic Conditions
20 For Type of Roadway (Gravel, Dirt, etc.)
21 For Ice or Snow on Roadway
22 Rain or Wet Roadway
23 Wind
24 Other Weather Conditions
25 Vehicle Condition
26 View Obstruction
27 On Curve/Turn
28 Impeding Traffic
29 Other

IMPROPER TURN

30 From Wrong Lane
31 From Direct Course
32 Right
33 Left
34 Turn About/U-Turn
35 To Enter Private Drive
36 In Front of Oncoming Traffic
37 Other

CHANGED LANES UNSAFELY

38 STOPPED IN TRAFFIC LANE

FAILED TO STOP

40 For Stop Sign
41 For Traffic Signal
42 For School Bus
43 For Railroad Gates/Signal
44 For Officer/Flagman
45 At Sidewalk/Stopline
46 Other

UNSAFE VEHICLE

47 Brakes
49 Steering

49 Tires

50 Suspension
51 Headlights
52 Tail Lights
53 Stop Lights
54 Wheel
55 Exhaust System
56 Windshield Wipers
57 Other Mechanical Defects

LEFT OF CENTER

58 In Meeting
59 No Passing Zone (Unmarked)
60 Marked Zone
61 Other

IMPROPER OVERTAKING

62 In Marked Zone
63 On Hill/Curve
64 At Intersection
65 Without Sufficient Clearance
66 Other

IMPROPER PARKING

67 On Roadway
68 Where Prohibited
69 Other

INATTENTION

70 Distracted by Passenger in Vehicle
71 Other Distraction Inside Vehicle
72 Distraction From Outside Vehicle
73 Other

WRONG WAY

74 On One Way
75 On Exit Ramp
76 On Entrance Ramp
77 Other

IMPROPER START FROM

78 Parked Position
79 Other

ALCOHOL-DUI/DWI

81 DRUG-DUI

OTHER IMPROPER ACT/ MOVEMENT

82 Failed to Signal
83 Disregarded Warning Signal
84 Improper Use of Lane
85 Improper Backing
86 Apparently Sleepy
87 Failed to Secure Load
88 Other/Unknown

UNKN/NO IMPROPER ACT

89 Deer in Roadway
90 Animal in Roadway
91 Domestic Animal in Rdwy
92 Avoiding Other Vehicle
93 Avoiding Pedestrian
94 Object/Debris in Roadway
95 Defect in Roadway
96 Abnormal Traffic Control
97 Improper Bicyclist Action
98 NO IMPROPER ACTION BY DRIVER
99 PEDESTRIAN ACTION

Vehicle Removal

0 Not Applicable
1 Towed Due to Vehicle Damage
2 Towed For Reasons Other Than Damage
3 Remained at Scene
4 Driven from Scene
5 Unknown

Vehicle Condition

00 Not Applicable
01 Apparently Normal
02 Brakes
03 Headlights
04 Steering
05 Tail Lights
06 Brake Lights
07 Tires/Wheels
08 Suspension
09 Signal lights
10 Windows
11 Truck Coupling/Trailer Hitch/Safety Chains
12 Mirrors
13 Wipers
15 Other
14 Power Train
99 Unknown

Special Function of Vehicle

00 Not Applicable
01 School Bus
02 Transit Bus
03 Intercity Bus
04 Charter Bus
05 Other Bus
06 Military
07 OHP
08 Other Police
09 Other Law Enforcement
10 Ambulance
11 Fire Truck
12 Public Owned Vehicle
13 Highway Equipment
14 Special Mobilized Machine
15 Other

Vehicle Condition

00 Not Applicable
01 Apparently Normal
02 Brakes
03 Headlights
04 Steering
05 Tail Lights
06 Brake Lights
07 Tires/Wheels
08 Suspension
09 Signal lights
10 Windows
11 Truck Coupling/Trailer Hitch/Safety Chains
12 Mirrors
13 Wipers
15 Other
14 Power Train
99 Unknown

Emergency Vehicle Responding to an Emergency

0 N/A
1 Yes
2 No
9 Unknown

Point of First Contact on Vehicle

Unit 1 0 9 **Unit 2** 1 2

Most Damaged Area

Unit 1 0 9 **Unit 2** 1 2

13 Top
14 Undercarriage
15 Non-Collision
99 Unknown



Latitude N Longitude W Railroad Crossing Number Roadway Orientation Unit Number 0 1 NE SW S Unit Number 0 2 NE SW W

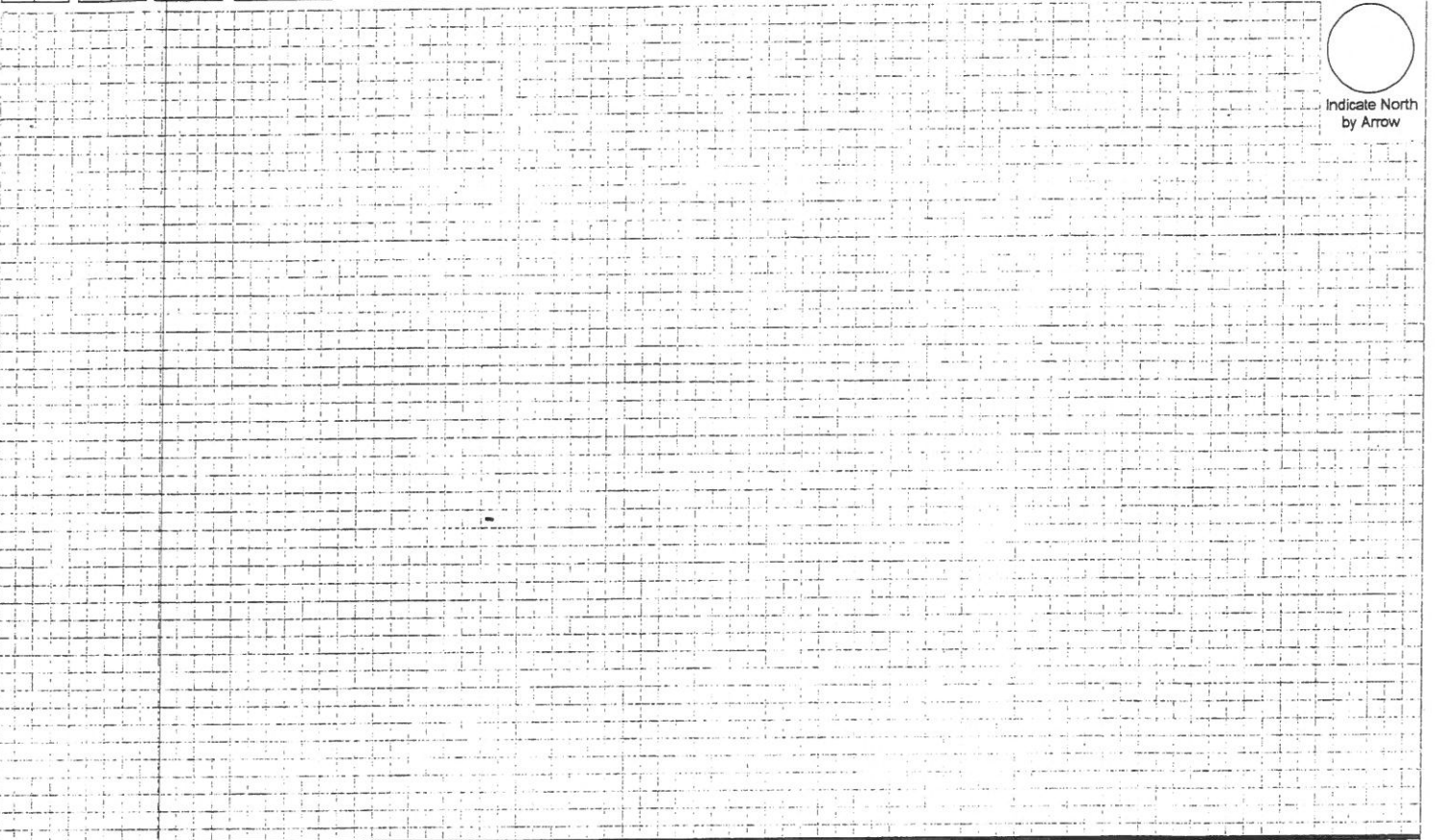
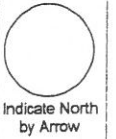

COLLISION EVENTS

Unit 0 1	First Event 3 4	Second Event <input type="text"/>	Third Event <input type="text"/>	Fourth Event <input type="text"/>	Most Harmful Event 3 4	First Harmful Event for the Entire Collision 3 4
Unit 0 2	First Event 3 4	Second Event <input type="text"/>	Third Event <input type="text"/>	Fourth Event <input type="text"/>	Most Harmful Event 3 4	

- | | | | |
|--|---|-------------------------------------|-----------------------------------|
| 00 Not Applicable | 21 Fell/Jumped From Motor Vehicle | 37 Work Zone/Maintenance Equipment | 56 Pavement Drop-Off |
| 10 Overturn/Rollover | 22 Thrown Or Falling Object | 38 Other Non-Fixed Object | 57 Ditch |
| 11 Fire/Explosion | 23 Other Non-Collision | FIXED OBJECT: | 58 Embankment |
| 12 Immersion | PERSON, MOTOR VEHICLE, OR NON-FIXED OBJECT: | 40 Barrier (Cable) | 59 Tree (Standing) |
| 13 Jackknife | 30 Pedestrian Pedal | 41 Barrier (Concrete) | 60 Dividing Strip |
| 14 Cargo/Equipment | 31 Cycle | 42 Barrier (Other) | 61 Retaining Wall |
| 15 Equipment Failure (Blown Tire, Brake Failure, etc.) | 32 Railway Vehicle (train, engine) | 43 Fence Pole | 62 Bridge Abutment |
| 16 Separation of Units | 33 Animal | 44 Fence | 63 Bridge Pier or Support |
| 17 Departed Road Right | 34 Motor Vehicle in Transport | 45 Traffic Signal Support | 64 Bridge Rail |
| 18 Departed Road Left | 35 Parked Motor | 46 Traffic Sign Support | 65 Bridge Post |
| 19 Cross Median/Centerline | 36 Vehicle Struck by Falling, Shifting Cargo or Anything Set in Motion by Motor Vehicle | 47 Utility Pole/Light Support | 66 Bridge Curb |
| 20 Downhill Runaway | | 48 Other Post/Pole/Support | 67 Bridge Super Structure (Beams) |
| | | 49 Guardrail/Guardrail Face | 68 Bridge Overhead Structure |
| | | 50 Guardrail End | 69 Delineator |
| | | 51 Culvert | 70 Mailbox |
| | | 52 Curb | 71 Other Fixed Object |
| | | 53 Island | 72 Other Highway Structure |
| | | 54 Sand Barrels | 73 Ground |
| | | 55 Impact Attenuator/ Crash Cushion | 99 Unknown |

Remarks

Unit #1 was south bound on Belmar Cir. Unit #2 (animal control unit) was making a U-turn on the cutover in front of the guard shack on Belmar Cir. Neither driver could see the other unit *due to* trees and guard shack. The front of unit #2 struck the left side of unit #2 at the drivers door.

Unit #1 was towed to a body shop at owners request and driver #1 was taken to medical facility by a relative to be checked over. Driver #1 stated that she had a bump on her head and that her knee was sore.

POI was approx. 8' east of the west curbline of Belmar Cir. and approx. 58' north of the north curbline of Indian Hills Rd.

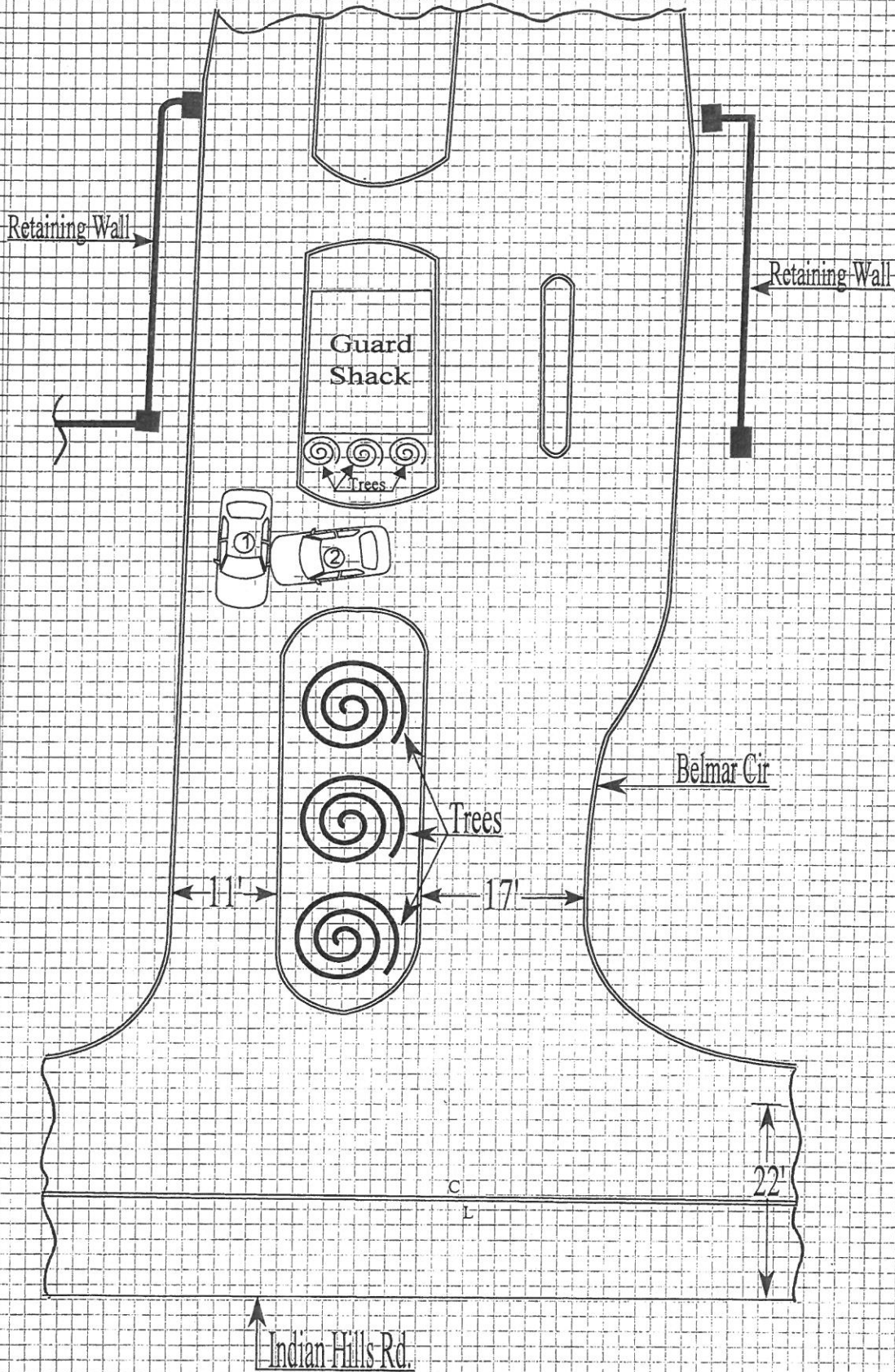

J
c

