

**PRELIMINARY PLAT**  
**RED CANYON RANCH**  
 A PLANNED UNIT DEVELOPMENT  
 A PART OF THE S.E. 1/4, SECTION 6, T8N, R28E, 11M  
 NORMAN, CLEVELAND COUNTY, OKLAHOMA

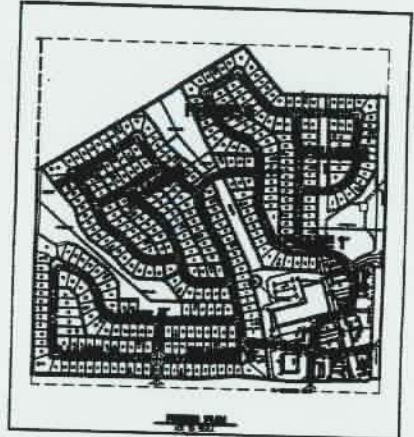

- RESIDENTIAL LOTS - 220
  - COMMERCIAL LOTS - 18
  - OPEN SPACE AREA - 22 AC.
1. THE BOUNDARIES OF THE LOTS AND AREAS OF OPEN SPACE ARE SHOWN BY THE DASHED LINE AND THE CITY OF NORMAN HAS BEEN RECORDED.
  2. ALL LOTS SHALL BE CONVEYED BY DEED TO THE CITY OF NORMAN FOR THE PURPOSES OF THIS PLAT.
  3. THERE IS NO RESERVE POWER FOR THESE LOTS.
  4. ALL LOTS SHALL BE CONVEYED BY DEED TO THE CITY OF NORMAN FOR THE PURPOSES OF THIS PLAT.
  5. ALL LOTS SHALL BE CONVEYED BY DEED TO THE CITY OF NORMAN FOR THE PURPOSES OF THIS PLAT.
  6. ALL LOTS SHALL BE CONVEYED BY DEED TO THE CITY OF NORMAN FOR THE PURPOSES OF THIS PLAT.
  7. ALL LOTS SHALL BE CONVEYED BY DEED TO THE CITY OF NORMAN FOR THE PURPOSES OF THIS PLAT.

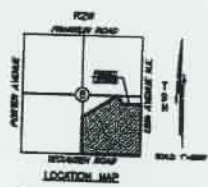

**OWNER / DEVELOPER**  
 RED CANYON RANCH, L.L.C.  
 1300 N. PARKER  
 NORMAN, OKLAHOMA 73071

**PRELIMINARY PLAT**  
 RED CANYON RANCH  
 A PLANNED UNIT DEVELOPMENT  
 1300 AC. S.E. & NEIGHBORING RD.  
 NORMAN, OKLAHOMA

DATE	BY	CHKD BY

