

**GRANT OF EASEMENT**

Parcel 11 – Trinity  
City of Norman, Oklahoma  
SE Bishop Sewer Interceptor

KNOW ALL MEN BY THESE PRESENTS:

THAT Trinity Baptist Church of Christ (GRANTOR), in consideration of the sum of Sixty-five thousand, six hundred and nine Dollars (\$65,609), receipt of which is hereby acknowledged, and for and upon other good and valuable considerations, do hereby grant, bargain, sell, and convey unto the City of Norman (CITY), a municipal corporation, a public utility easement over, across, and under the following described real estate and premises situated in the City of Norman, Cleveland County, Oklahoma, to wit:  
See "Exhibit A"

with the right of ingress and egress to and from the same, for the purpose of surveying, laying out, constructing, maintaining, and operating a public sanitary sewer line.

To have and to hold the same unto the said City, its successors, and assigns forever.

SIGNED and delivered this 12<sup>th</sup> day of DECEMBER, 20 13.

Trinity Baptist Church of Christ

BY:

Randy Presley

PASTOR OF WORSHIP

Title

REPRESENTATIVE ACKNOWLEDGMENT

STATE OF OKLAHOMA, COUNTY OF CLEVELAND, SS:

Before me, the undersigned, a Notary Public in and for the said State and County, on this 12<sup>th</sup> day of December, 20 13, personally appeared Randy Presley, to me known to be the identical person(s) who executed the foregoing grant of easement as a free and voluntary act and deed for the uses and purposes therein set forth.

WITNESS my hand and seal the day and year last above written.

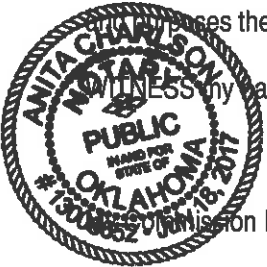

Notary Public:

Anita Charles

Seal:

Commission Expires: 7/18/2017

Approved as to form and legality this 2<sup>nd</sup> day of January, 20 14.

John B. [Signature]

City Attorney

Approved and accepted by the Council of the City of Norman, this \_\_\_\_\_ day of \_\_\_\_\_, 20 \_\_\_\_.

ATTEST:

Mayor

SEAL:

City Clerk

**Parcel (11)**  
**Proposed Permanent Easement**

A tract of land located in the Northeast Quarter of Section 9, Township 8 North, Range 2 West of the Indian Meridian, Cleveland County, Oklahoma, being more particularly described as follows;

Commencing at the Southeast corner of said Northeast Quarter;

Thence North 00°07'12" West, along the East line of said Northeast Quarter, a distance of 659.00 feet;

Thence South 89°52'44" West a distance of 33.00 feet to the Point of Beginning;

Thence continuing South 89°52'44" West a distance of 752.00 feet;

Thence North 00°07'12" West a distance of 30.00 feet;

Thence North 89°52'44" East a distance of 722.00 feet;

Thence North 00°07'12" West a distance of 782.07 feet;

Thence North 89°52'44" East a distance of 30.00 feet;

Thence South 00°07'12" East a distance of 812.07 feet; to the POINT OF BEGINNING, containing 46,022.1 square feet more or less.

Basis of Bearings – Oklahoma State Plane Grid Bearings

This legal description created on 4/11/13 by

  
Robby L. Johnson, PLS 1539



G:\Projects\04100\LLS-Data\Find\User Directory\RLJ\130410 parcel updates\Parcel 11.dwg Dec 20, 2013 - 2:58pm

Point of Commencing  
Southeast Cor., NE/4,  
Sec. 9, T8N, R2W

S89°52'44"W  
33.00'

SE 24TH AVE.

N00°07'12"W  
659.00'

33' Statutory ROW

S00°07'12"E - 812.07'

Point of Beginning

N89°52'44"E  
30.00'

N00°07'12"W - 782.07

Trinity Baptist  
Church of Christ

Parcel (11)  
Proposed Permanent Easement  
+/- 46,022.1 sq. feet

N89°52'44"E - 722.00'

S89°52'44"W - 752.00'

N00°07'12"W  
30.00'

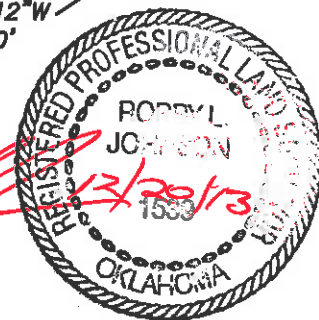
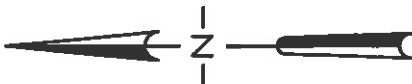

LEMKE LAND SURVEYING, Inc.



3226 BART CONNER DR., NORMAN, OK 73072  
PH.(405)368-8541 FAX(405)368-8540  
CA # 2054 EXP.DATE 6/30/14  
<http://www.lemke-la.com>

Designed by:  
Drawn By: BW  
Approved by: RLJ  
Date: 4/11/13  
Scale: 1"=150'  
Project No: 04100

Project: PARCEL (11) PROPOSED  
PERMANENT EASEMENT  
Project Location: PART OF THE NE/4, SEC. 9, T8N, R2W  
OF THE I.M., CLEVELAND CO., OKLAHOMA  
Client:

Sheet  
Number

1

Sheet 1 of 1