

PRELIMINARY PLAT
SOUTH LAKE ADDITION SECTION 11
 A PART OF THE S. 1/2, SECTION 9, T8N, R2W, I.M.
 NORMAN, CLEVELAND COUNTY, OKLAHOMA

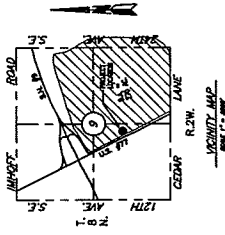

- NOTES:
1. DISTINGUISHING IS C-1, C-2, AND D-1. PROPOSED TO REZONE THE D-1 TO C-1.
 2. ALL PUBLIC UTILITIES SHALL BE DEPICTED IN ACCORDANCE WITH THE CITY OF NORMAN STANDARDS.
 3. ALL RECORDS SHALL BE CONSTRUCTED IN ACCORDANCE WITH THE FINAL PLANS.
 4. ALL PUBLIC UTILITIES SHALL BE IN DEPICTED STANDARDS.
 5. ALL SURVEY BOUNDARIES SHALL BE 5' OR MORE UNLESS NOTED OTHERWISE.
 6. ALL WIDTHS SHALL BE 5' OR MORE UNLESS NOTED OTHERWISE.
 7. TREE INDICATED TO BE SPACED A MINIMUM OF 500' APART.

BENCH MARK: TOP OF B.M. EXIST. MANHOLE AT THE N.W. CORNER OF THE PROPERTY CORNER SOUTH AND EAST OF THE PROPERTY CORNER OF Q.S.N. 9 & U.S. HWY. 77. ELEV. = 1160.30

BLOCK 1, LOT 1 = 1.20 ACRES
 LOT 2 = 1.09 ACRES
 LOT 3 = 1.18 ACRES
 LOT 4 = 1.20 ACRES
 LOT 5 = 1.20 ACRES

BLOCK 2, LOT 1 = 1.04 ACRES
 LOT 2 = 1.24 ACRES
 LOT 3 = 1.24 ACRES
 LOT 4 = 1.27 ACRES

TOTAL AREA = 10.66 ACRES

OWNER/DEVELOPER
 SOUTH LAKE GROUP, L.L.C.
 1800 N. INTERSTATE DR.
 SUITE 300
 NORMAN, OK 73072
 (405) 328-1460

DESIGNED BY:
 SPEAR & McCAULEY CO., P.C.
 815 W. MAIN
 OKLAHOMA CITY, OK 73106
 (405) 232-7715

PRELIMINARY PLAT	
SOUTH LAKE ADDITION SECTION 11	
U.S. HWY. 77 & O.S.H. #9	
NORMAN, OKLAHOMA	
SPEAR & McCAULEY CO., P.C. 815 W. MAIN OKLAHOMA CITY, OK 73106 (405) 232-7715 FAX: (405) 232-7716	SMC 1160 S. MAIN OKLAHOMA CITY, OK 73106 (405) 232-7715 FAX: (405) 232-7716
DATE: 11/12/2014	SHEET NO. 1
DRAWN BY: JLD	SCALE: 1" = 100'
CHECKED BY: JLD	PROJECT NO.
APPROVED BY: JLD	FORWARD: TRILLI, McCAULEY, P.C.

