

**FINAL PLAT**  
**HIGHLAND VILLAGE ADDITION SECTION 7**  
 A PART OF THE E. 1/2, SECTION 18, T9N, R2W, I.M.  
 NORMAN, CLEVELAND COUNTY, OKLAHOMA

Surveyed 2013 by  
 SMC Consulting Engineers  
 11-10-2013  
 11-10-2013  
 Cleveland County, OK

STATE OF OKLAHOMA  
 COUNTY OF CLEVELAND  
**LED FOR RECORD**

UNPLATTED

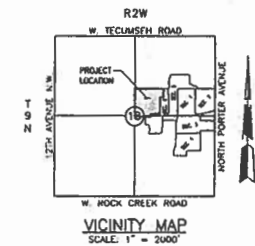

**TYPICAL BUILDING SETBACKS**

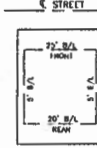

SCALE: 1" = 100'

BASIS OF BEARING FOR THIS FINAL PLAT IS N 00°00'00" E AS SHOWN ON THE EAST LINE OF SEC. 18

LOT COUNT  
 RESIDENTIAL LOTS = 40

PERMANENT BENCHMARK:  
 BRASS CAP AT INTERSECTION OF TURNPIKE PARK TRAIL & HIGHLAND TRAIL  
 ELEV. = 1172.68

ALL COMMON AREAS, OPEN SPACES, ETC. WILL BE MAINTAINED BY A MAINTENANCE PROPERTY OWNERS ASSOCIATION.

\* UNLESS OTHERWISE NOTED, L.P.'S W/ C.A. 890 CAPS WERE SET AT ALL PROPERTY CORNERS.

Date: December 31, 2013  
 SMC Consulting Engineers  
 815 W. Main Street  
 Oklahoma City, OK 73108  
 PH: (405) 232-7715  
 Oklahoma, California Exp. 8-30-2015  
**SHEET 2 OF 2**

**CURVE TABLE**

CURVE DATA	CHORD BEARING	CHORD LENGTH	CHORD BEARING	CHORD LENGTH
C1	N 89°00'00" W	324.69	N 89°00'00" W	324.69
C2	N 89°00'00" W	181.51	N 89°00'00" W	181.51
C3	N 89°00'00" W	181.51	N 89°00'00" W	181.51
C4	N 89°00'00" W	181.51	N 89°00'00" W	181.51
C5	N 89°00'00" W	181.51	N 89°00'00" W	181.51

**STORM DRAINAGE DETENTION FACILITY EASEMENT**

DRAINAGE DETENTION FACILITY EASEMENTS ARE HEREBY ESTABLISHED AS SHOWN TO PROVIDE FOR DETENTION OF STORM SURFACE WATER AND CONSTRUCTED AS APPROVED BY THE CITY ENGINEER. ALL MAINTENANCE WITHIN THE DRAINAGE DETENTION FACILITY EASEMENT SHALL BE THE RIGHT, DUTY AND RESPONSIBILITY OF THE PROPERTY OWNER(S) IN THE PLAT OF HIGHLAND VILLAGE ADDITION SECTION 7. HOWEVER, IF MAINTENANCE IS NEGLECTED OR SUBJECT TO OTHER UNUSUAL CIRCUMSTANCES AND IS DETERMINED TO BE A HAZARD OR THREAT TO PUBLIC SAFETY BY THE CITY ENGINEER, CORRECTIVE MAINTENANCE MAY BE PERFORMED BY THE GOVERNING JURISDICTION WITH COSTS ASSESSED TO AND BORNE UPON SAID PROPERTY OWNER(S). OFFICIALS REPRESENTING THE ENGINEERING DIVISION, PUBLIC WORKS DEPARTMENT, SHALL HAVE THE RIGHT TO LIMIT UPON THE EASEMENT FOR PURPOSES OF PERIODIC INSPECTION AND/OR CORRECTIVE MAINTENANCE OF THE FACILITY. UPON RECEIVING WRITTEN APPROVAL FROM THE ENGINEERING DIVISION, PUBLIC WORKS DEPARTMENT, PROPERTY OWNER(S) MAY CONSTRUCT IMPROVEMENTS WITHIN THE EASEMENT, PROVIDED THE IMPROVEMENT DOES NOT INTERFERE WITH THE FUNCTION OF THE DETENTION FACILITY.

NOTE: THE UNIT OF MEASUREMENT SHOWN FOR ALL DIMENSIONS ON THE FINAL PLAT IS U.S. SURVEY FEET.