

PRELIMINARY SITE DEVELOPMENT PLAN
FLINT HILLS ADDITION
 A PLANNED UNIT DEVELOPMENT
 A PART OF THE S.E. 1/4, SECTION 12, T9N, R3W, I.M.
 NORMAN, CLEVELAND COUNTY, OKLAHOMA

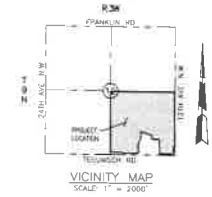

- NOTES:
1. ALL MATERIALS AND USE PLANS SHOWN ON LOTS 1 THRU 4, BLOCK 11, LOTS 1 THRU 8, BLOCK 12, LOT 1, BLOCK 13 AND LOT 1, BLOCK 14 ARE CONCEPTUAL. THESE ARE SUBJECT TO LANDSCAPE ARCHITECTURE AND OTHER PROFESSIONAL REQUIREMENTS. FINAL SITE DEVELOPMENT PLANS WILL BE REQUIRED.
 2. TURNING RADIUS WITHIN PARKING AREAS SHALL ACCOMMODATE THE LARGEST RESPONDING VEHICLES.
 3. ALL REQUIRED FACADE COVERSAGES WILL BE OBTAINED TO MEET CITY REQUIREMENTS AT FINAL PLAN STAGE.

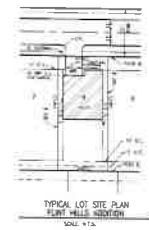

DESIGNED BY:
 SMC CONSULTING ENGINEERS, P.C.
 812 W. MAIN
 NORMAN CITY, OKLAHOMA 73106
 PHONE: (405) 212-7125

DEVELOPER:
 LANDMARK LAND, LLC
 2500 WASHINGTON DR
 NORMAN, OK 73109
 PHONE: (405) 400-8816

OWNER:
 KIM CONNALLY
 10819 W. 52ND DR
 NORMAN, OK 73109
 PHONE: (405) 751-6025



FLINT HILLS ADDITION
 TECUMSEH RD. & 12TH AVE. NW
 NORMAN, OKLAHOMA



PRELIMINARY SITE DEVELOPMENT PLAN
 SCALE: 1" = 100'

