

EXHIBIT

36TH AVENUE NW

East R/W Line

N00°35'55"W
55.00'

N89°24'05"E
50.00'

N89°24'05"E
15.00'

Temporary
Driveway
Easement

S00°35'55"E
55.00'

S89°24'05"W
15.00'

POINT OF BEGINNING

Section Line
N00°35'55"W ~ 374.38'

Permanent East R/W

C & M Real Estate, LLC
Book 5373, Page 1078

Ex. 33' R/W

POINT OF COMMENCEMENT
SW/C, SW/4 Sec. 2
T-9-N, R-3-W, I.M.

Section Line

FRANKLIN ROAD

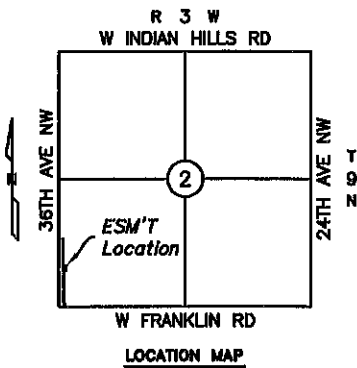

Scale 1" = 100'

BASIS OF BEARING: N 00°35'55" E = West
line SW/4 Section 2, T-9-N, R-3-W, I.M.

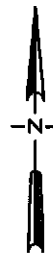

LEMKE LAND SURVEYING, LLC



3226 BART CONNER DRIVE, NORMAN, OK 73072
PH.(405)366-8541 FAX(405)366-8540
CA # 8976
<http://www.lemke-ls.com>

Surveyed By: PR/DB
Drawn By: SA
Approved By: KJH
Date: 12/07/2017
Scale: 1" = 100'
Project No: 13065

Project: TEMPORARY DRIVEWAY EASEMENT
(PARCEL 4.2) STATE JOB PIECE NO. 28918(04)
Project Location: PT. SW/4 SECTION 2, T-9-N, R-3-W, I.M.
CLEVELAND COUNTY, OKLAHOMA
Client: CITY OF NORMAN

Sheet Number

1

Sheet 1 of 1