

EXHIBIT

36TH AVENUE NW

East R/W Line

N00°35'55"W ~ 973.00'

N00°35'55"E ~ 429.38'

Section Line

Ex. 33' R/W

N89°24'05"E
50.00'

POINT OF COMMENCEMENT
SW/C, SW/4 Sec. 2
T-9-N, R-3-W, I.M.

Section Line

S15°43'23"E
153.31'

S00°35'55"E
180.00'

S14°19'58"W
77.62'

S00°35'55"E
225.00'

Drainage Easement

S11°54'31"E
101.98'

S00°35'55"E
125.00'

S17°50'11"W
126.49'

POINT OF BEGINNING

Permanent East R/W Line

C & M Real Estate, LLC
Book 5373, Page 1078

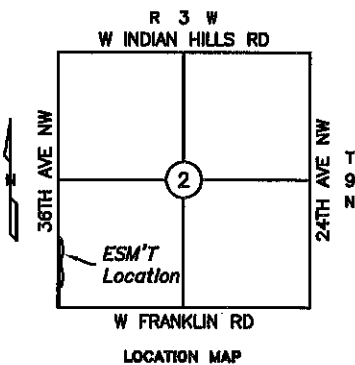

FRANKLIN ROAD

Scale 1" = 200'

BASIS OF BEARING: N 00°35'55" E = West line SW/4 Section 2, T-9-N, R-3-W, I.M.

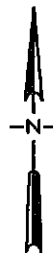

LEMKE LAND SURVEYING, LLC



3228 BART CONNER DRIVE, NORMAN, OK 73072
PH.(405)388-8541 FAX(405)388-8540
CA # 8976
http://www.lemke-la.com

Surveyed By: PR/DB
Drawn By: SA
Approved By: KJH
Date: 3/7/2017
Scale: 1" = 200'
Project No: 13065

Project: DRAINAGE EASEMENT (PARCEL 4.1)
STATE JOB PIECE NO. 26918 (04)
Project Location: PT. SW/4 SECTION 2, T-9-N, R-3-W, I.M.
CLEVELAND COUNTY, OKLAHOMA
Client: CITY OF NORMAN

Sheet Number

1

Sheet 1 of 1