

Parcel No: 7
Project No:
J/P No: 26918(04)

GRANT OF EASEMENT
City of Norman

Know all men by these presents:

That Raymond F. Eginton, a single person, for and in consideration of the sum of Ten Dollars and Other Valuable Consideration (\$10.00 and OVC), receipt of which is hereby acknowledged, and for and upon other good and valuable considerations, do hereby grant, bargain, sell and convey unto the City of Norman, a municipal corporation, a public utility easement and right-of-way over, across, and under the following described real estate and premises situated in the City of Norman, Cleveland County, Oklahoma, the following described land to wit:

See attached Legal Description for Parcel 7

With the right of ingress and egress to and from the same, for the purpose of surveying, laying out, constructing, maintaining, and operating a public roadway, drainage structure or utility.

PUBLIC ROADWAY, DRAINAGE AND UTILITIES

To have and to hold the same unto the said city, its successors, and assigns forever.

Signed and delivered this 5 day of July, 2019.

Raymond F. Eginton, a single person:

Raymond F. Eginton _____
Title _____

REPRESENTATIVE ACKNOWLEDGEMENT

NEW YORK, QUEENS
STATE OF ~~OKLAHOMA~~, COUNTY OF ~~CLEVELAND~~, SS:

Before me, the undersigned, a Notary Public in and for said County and State, on this 5th day of JULY, 2019, personally appeared RAYMOND F. EGINTON, to me known to be the identical person(s) who executed the foregoing grant of easement and acknowledged to me that HE executed the same as HIS free and voluntary act and deed for the uses and purposes therein set forth.

WITNESS my hand and seal the day and year last above written.

MARCIA M PHILLIPS
NOTARY PUBLIC, STATE OF NEW YORK
01PHS152203
QUALIFIED IN QUEENS COUNTY
COMMISSION EXPIRES SEPTEMBER 25, 2022

My Commission Expires: 9-25-2022 Notary Public: Marcia M Phillips

Approved as to form and legality this _____ day of _____, 20____.

City Attorney

Approved and accepted by the Council of the City of Norman, this _____ day of _____, 20____.

Mayor

ATTEST:

City Clerk
SEAL:

Parcel 7.0
State Job Piece No. 26918(04)
Raymond F. Eginton
Proposed Right-of-Way
36th Avenue NW

A strip, piece or parcel of land lying in the SE $\frac{1}{4}$, Section 10, T9N, R3W, Cleveland County, Oklahoma. Said parcel of land being described by metes and bounds as follows:

Beginning at a point on the West right-of-way line of 36th Avenue NW a distance of 941.01 feet N 00°11'16" W of and 33.00 feet S 89°41'36" W of the SE corner of said SE $\frac{1}{4}$, thence continuing S 89°41'36" W along said right-of-way line a distance of 17.00 feet, thence N 00°11'16" W parallel with said right-of-way line a distance of 339.00 feet to a point on said right-of-way line, thence N 89°41'36" E along said right-of-way line a distance of 17.00 feet, thence S 00°11'16" E continuing along said right-of-way line a distance of 339.00 feet to point of beginning.

Containing 0.13 acres, more or less, of new right-of-way.

This legal description was prepared under the direct supervision of Kelly J. Henderson, PLS. The Basis of bearing is the East line of the SE $\frac{1}{4}$ having a bearing of S 00°11'16" E.

Kelly J. Henderson, PLS



EXHIBIT

LOT 29

LOT 30

3

LOT 31

Existing
50' R/WN89°41'36"E
17.00'Existing Existing
33' R/W 33' R/W

N00°11'16"W ~ 339.00'

S00°11'16"E ~ 339.00'

RAYMOND F. EGINTON
Book 2033 Page 915Proposed R/W
West R/W Line

36TH AVENUE NW

S89°41'36"W
17.00'

POINT OF BEGINNING

LOT 29

LOT 30

LOT 31

CASTLEROCK ADDITION SECTION 6

3

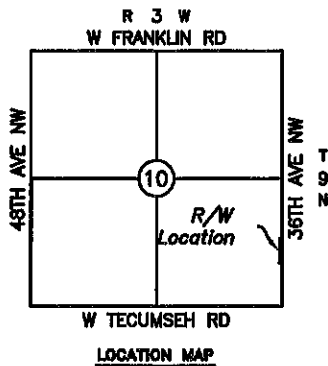
S89°41'36"W
33.00'Existing
50' R/WN00°11'16"W
941.01POINT OF COMMENCEMENT
SE/C SE/4 Section 10,
T-9-N, R-3-W, I.M.

Scale 1" = 60'

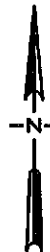
BASIS OF BEARING: S 00°11'16" E = East
line SE/4 Section 10, T-9-N, R-3-W, I.M.

LEMKE LAND SURVEYING, LLC

S L
L S3226 BART CONNER DRIVE, NORMAN, OK 73072
PH.(405)366-8641 FAX(405)366-8640
CA # 6075
<http://www.lemke-la.com>

Surveyed By: PR/DB

Drawn By: GT

Approved By: KJH

Date: 03/04/2019

Scale: 1" = 60'

Project No: 13065

Project:

PROPOSED R/W (PARCEL 7.0)
STATE JOB PIECE NO. 26918(04)

Project Location:

PT. SE/4 SECTION 10, T-9-N, R-3-W, I.M.
CLEVELAND COUNTY, OKLAHOMA

Client:

CITY OF NORMAN

Sheet
Number

1

Sheet 1 of 1