

FINAL PLAT
SPRINGS AT GREENLEAF TRAILS ADDITION SECTION 2
 A PLANNED UNIT DEVELOPMENT
 A PART OF THE N.W. 1/4, SECTION 18, T9N, R2W I.M.
 NORMAN, CLEVELAND COUNTY, OKLAHOMA

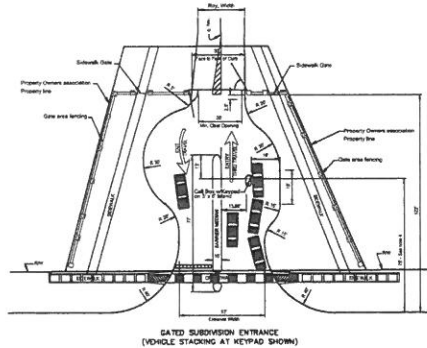

- NOTES:**
1. A Self-Operated System (SOS) shall be provided that will automatically open the gates upon approach of emergency vehicles.
 2. A manual gate release mechanism shall be provided to allow a responder to open the gate upon the loss of power to the gate controls.
 3. There must be at least one 30' clear width gate opening and minimum clear height of 12'6" to accommodate emergency vehicles.
 4. Minimum turning radius for gated entrance intersecting urban local and collector streets shall be 50 feet. For gated entrance intersections, arterial and rural collector roads the minimum turning radius shall be 75 feet for developments with less than 100 lots. Additional turning radius may be required if the number of lots served by the gated entrance exceeds 100.
 5. Gating gates must open in the direction of normal traffic flow and must not impede pedestrian traffic or farmstead traffic while opening or when in the open position.
 6. Gates, fences, etc. shall not interfere with or prevent access to fire hydrants. Area around hydrant(s) shall be kept clear of obstructions in accordance with City Standards.
 7. Turnaround area shall accommodate a single unit truck as described in Standard OC-04.
 8. A "Gate Release" may be constructed using current building codes and entrance, traveled way lanes and turn around area must be modified to accommodate the building.
 9. Any Proposed changes shall be reviewed and approved by the City Engineer, Traffic Engineer and the Fire Marshal's office.

GATED ENTRANCE LAYOUT
(NOT TO SCALE)

CURVE TABLE

STATION	CHORD BEARING	CHORD DISTANCE	CHORD BEARING	CHORD DISTANCE	CHORD BEARING	CHORD DISTANCE	CHORD BEARING	CHORD DISTANCE
1	N 89°12'48" E	100.00'	N 89°12'48" E	100.00'	N 89°12'48" E	100.00'	N 89°12'48" E	100.00'
2	N 89°12'48" E	100.00'	N 89°12'48" E	100.00'	N 89°12'48" E	100.00'	N 89°12'48" E	100.00'
3	N 89°12'48" E	100.00'	N 89°12'48" E	100.00'	N 89°12'48" E	100.00'	N 89°12'48" E	100.00'
4	N 89°12'48" E	100.00'	N 89°12'48" E	100.00'	N 89°12'48" E	100.00'	N 89°12'48" E	100.00'
5	N 89°12'48" E	100.00'	N 89°12'48" E	100.00'	N 89°12'48" E	100.00'	N 89°12'48" E	100.00'
6	N 89°12'48" E	100.00'	N 89°12'48" E	100.00'	N 89°12'48" E	100.00'	N 89°12'48" E	100.00'
7	N 89°12'48" E	100.00'	N 89°12'48" E	100.00'	N 89°12'48" E	100.00'	N 89°12'48" E	100.00'
8	N 89°12'48" E	100.00'	N 89°12'48" E	100.00'	N 89°12'48" E	100.00'	N 89°12'48" E	100.00'
9	N 89°12'48" E	100.00'	N 89°12'48" E	100.00'	N 89°12'48" E	100.00'	N 89°12'48" E	100.00'
10	N 89°12'48" E	100.00'	N 89°12'48" E	100.00'	N 89°12'48" E	100.00'	N 89°12'48" E	100.00'
11	N 89°12'48" E	100.00'	N 89°12'48" E	100.00'	N 89°12'48" E	100.00'	N 89°12'48" E	100.00'
12	N 89°12'48" E	100.00'	N 89°12'48" E	100.00'	N 89°12'48" E	100.00'	N 89°12'48" E	100.00'
13	N 89°12'48" E	100.00'	N 89°12'48" E	100.00'	N 89°12'48" E	100.00'	N 89°12'48" E	100.00'
14	N 89°12'48" E	100.00'	N 89°12'48" E	100.00'	N 89°12'48" E	100.00'	N 89°12'48" E	100.00'
15	N 89°12'48" E	100.00'	N 89°12'48" E	100.00'	N 89°12'48" E	100.00'	N 89°12'48" E	100.00'
16	N 89°12'48" E	100.00'	N 89°12'48" E	100.00'	N 89°12'48" E	100.00'	N 89°12'48" E	100.00'
17	N 89°12'48" E	100.00'	N 89°12'48" E	100.00'	N 89°12'48" E	100.00'	N 89°12'48" E	100.00'
18	N 89°12'48" E	100.00'	N 89°12'48" E	100.00'	N 89°12'48" E	100.00'	N 89°12'48" E	100.00'
19	N 89°12'48" E	100.00'	N 89°12'48" E	100.00'	N 89°12'48" E	100.00'	N 89°12'48" E	100.00'
20	N 89°12'48" E	100.00'	N 89°12'48" E	100.00'	N 89°12'48" E	100.00'	N 89°12'48" E	100.00'
21	N 89°12'48" E	100.00'	N 89°12'48" E	100.00'	N 89°12'48" E	100.00'	N 89°12'48" E	100.00'
22	N 89°12'48" E	100.00'	N 89°12'48" E	100.00'	N 89°12'48" E	100.00'	N 89°12'48" E	100.00'
23	N 89°12'48" E	100.00'	N 89°12'48" E	100.00'	N 89°12'48" E	100.00'	N 89°12'48" E	100.00'
24	N 89°12'48" E	100.00'	N 89°12'48" E	100.00'	N 89°12'48" E	100.00'	N 89°12'48" E	100.00'
25	N 89°12'48" E	100.00'	N 89°12'48" E	100.00'	N 89°12'48" E	100.00'	N 89°12'48" E	100.00'
26	N 89°12'48" E	100.00'	N 89°12'48" E	100.00'	N 89°12'48" E	100.00'	N 89°12'48" E	100.00'
27	N 89°12'48" E	100.00'	N 89°12'48" E	100.00'	N 89°12'48" E	100.00'	N 89°12'48" E	100.00'
28	N 89°12'48" E	100.00'	N 89°12'48" E	100.00'	N 89°12'48" E	100.00'	N 89°12'48" E	100.00'
29	N 89°12'48" E	100.00'	N 89°12'48" E	100.00'	N 89°12'48" E	100.00'	N 89°12'48" E	100.00'
30	N 89°12'48" E	100.00'	N 89°12'48" E	100.00'	N 89°12'48" E	100.00'	N 89°12'48" E	100.00'
31	N 89°12'48" E	100.00'	N 89°12'48" E	100.00'	N 89°12'48" E	100.00'	N 89°12'48" E	100.00'
32	N 89°12'48" E	100.00'	N 89°12'48" E	100.00'	N 89°12'48" E	100.00'	N 89°12'48" E	100.00'
33	N 89°12'48" E	100.00'	N 89°12'48" E	100.00'	N 89°12'48" E	100.00'	N 89°12'48" E	100.00'
34	N 89°12'48" E	100.00'	N 89°12'48" E	100.00'	N 89°12'48" E	100.00'	N 89°12'48" E	100.00'
35	N 89°12'48" E	100.00'	N 89°12'48" E	100.00'	N 89°12'48" E	100.00'	N 89°12'48" E	100.00'
36	N 89°12'48" E	100.00'	N 89°12'48" E	100.00'	N 89°12'48" E	100.00'	N 89°12'48" E	100.00'
37	N 89°12'48" E	100.00'	N 89°12'48" E	100.00'	N 89°12'48" E	100.00'	N 89°12'48" E	100.00'
38	N 89°12'48" E	100.00'	N 89°12'48" E	100.00'	N 89°12'48" E	100.00'	N 89°12'48" E	100.00'
39	N 89°12'48" E	100.00'	N 89°12'48" E	100.00'	N 89°12'48" E	100.00'	N 89°12'48" E	100.00'
40	N 89°12'48" E	100.00'	N 89°12'48" E	100.00'	N 89°12'48" E	100.00'	N 89°12'48" E	100.00'
41	N 89°12'48" E	100.00'	N 89°12'48" E	100.00'	N 89°12'48" E	100.00'	N 89°12'48" E	100.00'
42	N 89°12'48" E	100.00'	N 89°12'48" E	100.00'	N 89°12'48" E	100.00'	N 89°12'48" E	100.00'
43	N 89°12'48" E	100.00'	N 89°12'48" E	100.00'	N 89°12'48" E	100.00'	N 89°12'48" E	100.00'
44	N 89°12'48" E	100.00'	N 89°12'48" E	100.00'	N 89°12'48" E	100.00'	N 89°12'48" E	100.00'
45	N 89°12'48" E	100.00'	N 89°12'48" E	100.00'	N 89°12'48" E	100.00'	N 89°12'48" E	100.00'
46	N 89°12'48" E	100.00'	N 89°12'48" E	100.00'	N 89°12'48" E	100.00'	N 89°12'48" E	100.00'
47	N 89°12'48" E	100.00'	N 89°12'48" E	100.00'	N 89°12'48" E	100.00'	N 89°12'48" E	100.00'
48	N 89°12'48" E	100.00'	N 89°12'48" E	100.00'	N 89°12'48" E	100.00'	N 89°12'48" E	100.00'
49	N 89°12'48" E	100.00'	N 89°12'48" E	100.00'	N 89°12'48" E	100.00'	N 89°12'48" E	100.00'
50	N 89°12'48" E	100.00'	N 89°12'48" E	100.00'	N 89°12'48" E	100.00'	N 89°12'48" E	100.00'
51	N 89°12'48" E	100.00'	N 89°12'48" E	100.00'	N 89°12'48" E	100.00'	N 89°12'48" E	100.00'
52	N 89°12'48" E	100.00'	N 89°12'48" E	100.00'	N 89°12'48" E	100.00'	N 89°12'48" E	100.00'
53	N 89°12'48" E	100.00'	N 89°12'48" E	100.00'	N 89°12'48" E	100.00'	N 89°12'48" E	100.00'
54	N 89°12'48" E	100.00'	N 89°12'48" E	100.00'	N 89°12'48" E	100.00'	N 89°12'48" E	100.00'
55	N 89°12'48" E	100.00'	N 89°12'48" E	100.00'	N 89°12'48" E	100.00'	N 89°12'48" E	100.00'



SCALE: 1" = 100'
 THE BEARING OF S 89°43'11" E ON THE NORTH LINE OF THE NORTHWEST QUARTER OF SECTION 18 FOR THE CITY OF NORMAN U.S. DATUM WAS USED AS THE BASIS OF BEARING FOR THIS PLAT.
 TOTAL LOTS = 55

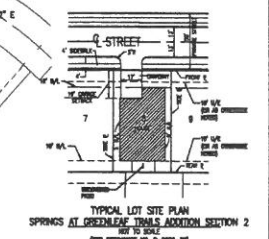

STORM DRAINAGE DETENTION FACILITY EASEMENT
 DRAINAGE DETENTION FACILITY EASEMENTS ARE HEREBY ESTABLISHED AS SHOWN TO PROVIDE FOR DETENTION OF STORM SURFACE WATER AND CONSTRUCTED AS APPROVED BY THE CITY ENGINEER. ALL MAINTENANCE WITHIN THE DRAINAGE DETENTION FACILITY EASEMENT SHALL BE THE RESPONSIBILITY AND MAINTENANCE OF THE PROPERTY OWNER(S) IN THE PLAT OF SPRINGS AT GREENLEAF TRAILS ADDITION SECTION 2. HOWEVER, IF MAINTENANCE IS REFUSED OR DELAYED BY THE PROPERTY OWNER(S), THE CITY ENGINEER IS AUTHORIZED TO PERFORM SUCH MAINTENANCE AND TO RECOVER THE COSTS THEREOF FROM THE PROPERTY OWNER(S). THE CITY ENGINEER'S OFFICIALS REPRESENTING THE ENGINEERING DESIGN FIRM SHALL HAVE THE RIGHT TO ENTER UPON THE EASEMENT FOR PURPOSES OF INSPECTION AND/OR CORRECTIVE MAINTENANCE OF THE FACILITY. UPON RECEIVING WRITTEN APPROVAL FROM THE ENGINEERING DESIGN FIRM, THE PROPERTY OWNER(S) MAY CONSTRUCT IMPROVEMENTS WITHIN THE EASEMENT, PROVIDED THE IMPROVEMENT DOES NOT INTERFERE WITH THE FUNCTION OF THE DETENTION FACILITY.

NOTE:
 COMMON OPEN SPACE AREAS WILL BE OWNED AND MAINTAINED BY "MANDATORY PROPERTY OWNERS' ASSOCIATION."

D/E = DRAINAGE EASEMENT
 ACCESS/E = ACCESS EASEMENT
 LMA = LIMITS OF NO ACCESS
 U/E = UTILITY EASEMENT
 B/L = BUILDING LINE
 -1111- = ADDRESS

BENCHMARK: SET BRASS CAP AT INTERSECTION OF DICKINSON RD. & CRAMPTON CAP W/ ELEV. =

Date: August 8, 2013
 SMC Consulting Engineers, P.C.
 818 N. Main Street
 Oklahoma City, OK 73106
 PH: (405) 233-7715
 CLEVELAND COUNTY, OKLAHOMA, 8/20/2013

NOTE: THE UNIT OF MEASUREMENT SHOWN FOR ALL DIMENSIONS ON THE FINAL PLAT IS U.S. SURVEY FEET.